

Kavya Saxena

Philadelphia, PA 19104 | (267) 361-9872 | saxena.kavya@outlook.com | [Linkedin](#)

EDUCATION

University of Pennsylvania, Master of Science in Design – Advanced Architectural Design Balwant Sheth School of Architecture, NMIMS Bachelor of Architecture	August 2024 – August 2025 Philadelphia, PA July 2019 – March 2024 Mumbai, India
---	--

PROFESSIONAL EXPERIENCE

PENN ENGINEERING – PLANNING DESIGN CONSTRUCTION Design Intern	November 2024 – August 2025 Philadelphia, Pennsylvania
---	---

- Designed and planned interior study spaces and collaborative areas for the university's engineering department using **Rhino 3D**, ensuring optimal functionality, accessibility, and adherence to university standards.
- Worked closely with prominent architects and university planners to coordinate design planning, attend project meetings, and present design proposals.
- Conducted site visits to document existing conditions and produced detailed plans to support the design development process.
- Assisted in the design of robotics labs, classrooms, and office spaces, focusing on efficient layouts that enhance usability for students and faculty.

ATELIER DOMAIN AND DESIGN Architecture Intern	March 2024 - August 2024 Mumbai, India
---	---

- Contributed to the design and construction of a luxury holiday villa in Alibaug, developing **layouts, landscaping details, and furniture planning** using **AutoCAD** and **SketchUp**.
- Created high-quality **renders** for the villa, helping visualize **material selections** and interior design elements.
- Coordinated with contractors for **fittings and detailing of bedrooms and bathrooms**, ensuring seamless execution of design intent.
- Assisted in the **post-production** of the firm's newly built office for a high-profile architectural competition, contributing to **final presentations** and **submission materials**.
- Developed **landscaping CAD details** for a gazebo and open terrace, refining outdoor spatial planning and material selection.
- Played a key role in the competition-winning submission, working on concept refinement and **presentation graphics**.

TALATI AND PARTNERS Architecture Intern	May 2023 - June 2023 Mumbai, India
---	---------------------------------------

- Assisted in the design and development of a **50-story high-rise residential tower**, producing detailed drawings and 3D models using Revit and SketchUp.
- Monitored construction progress and documented site conditions to ensure design accuracy and proper execution.
- Collaborated with senior architects to refine sectional design details for the tower's deck, contributing to high-quality and innovative architectural solutions.

RONAK HINGARH ARCHITECTURE + DESIGN Student Intern	May 2022 - June 2022 Mumbai, India
--	---------------------------------------

- Designed architectural layouts for a luxury weekend **villa scheme** comprising **6 plots spread over 5.2 acres on contoured terrain**, adapting plans to client requirements and coordinating with contractors and structural engineers to develop structural layouts and execution plans.
- Created **renders** and conceptual designs for an **affordable housing project**, providing practical design solutions.

INGRAIN ARCHITECTS Façade Designer	June 2021 - July 2021 Mumbai, India
--	--

- Designed innovative **facade features** and drafted **details**, contributing to both conceptual and detail design phases.
- Developed visual presentations with **Adobe Photoshop** and enhanced project visuals using **Enscape** for facade designs.

SKILLS

Technical Skills – Revit, AutoCAD, Rhinoceros 3D, Sketchup, Adobe Illustrator, Adobe Photoshop, Adobe InDesign, Lumion, V-Ray for Rhino, Keyshot, Enscape, Adobe Creative Suite, Bluebeam Revu, Microsoft Office Suite.

Certifications – Licensed Architect, Council of Architecture, India

AWARDS

- Architects Arena** – Honourable Mention for designing and curing interiors for, innovative office space.
- Kala Ghoda Arts Festival** – Team Pavilion selected for display at one of India's most prominent cultural festivals.
- Solar Decathlon India** – Pre-Final Stage for designing net-zero-energy-water buildings with industry collaboration.

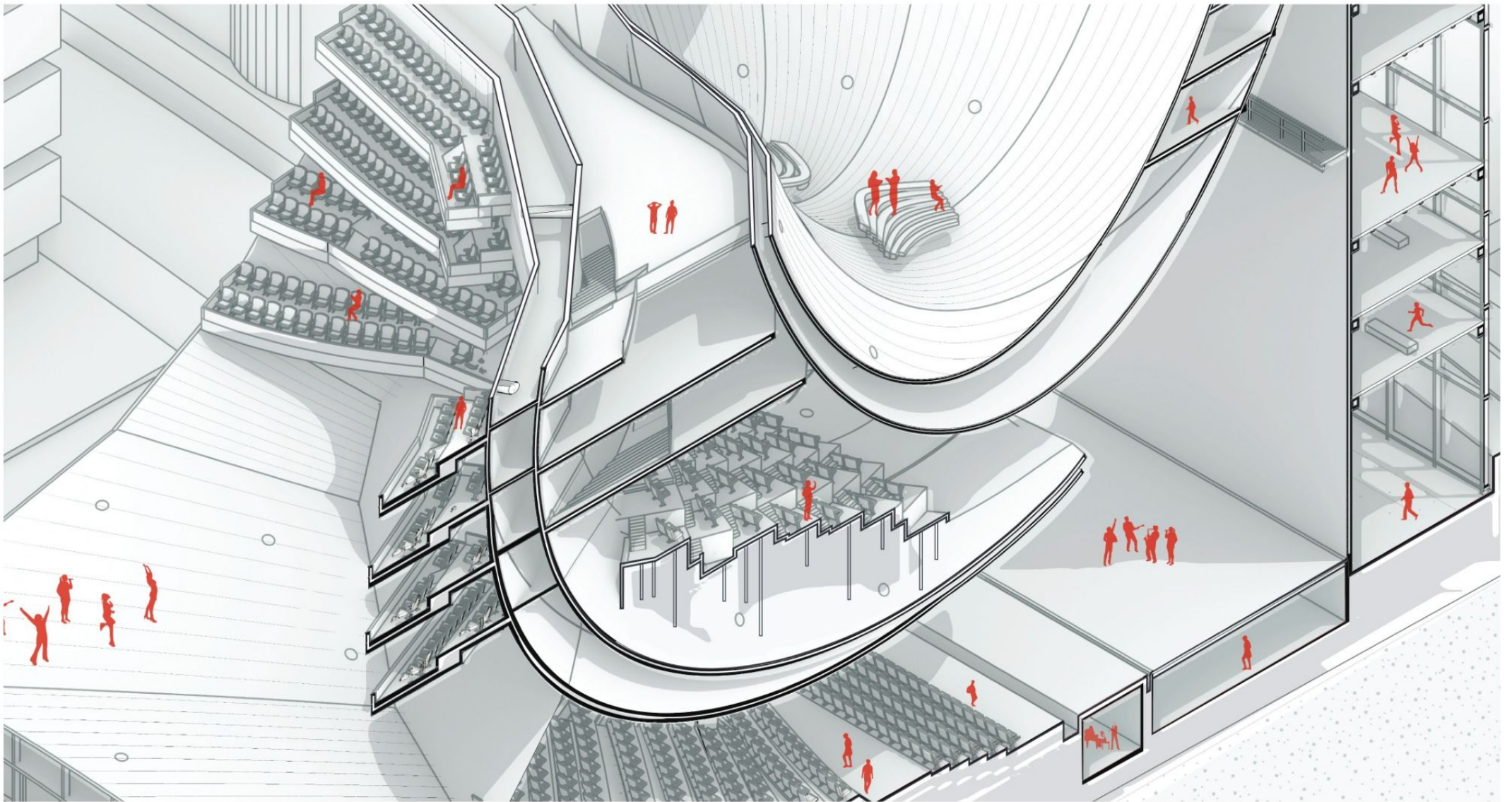

kavya saxena
portfolio.

selected works
2022 - 2025

- 01** THE MODEL DETAIL
Advanced Architecture Spring Studio
- 02** ASSET OFFICE BUILDINGS
Advanced Architecture Fall Studio
- 03** IMPACT AESTHETICS
Design Innovation Studio
- 04** ADND SILO
Professional Work
- 05** THESIS | URBAN REGENERATION
Design Dissertation
- 06** TRANSIT ORIENTED DEVELOPMENT
Architecture Design Studio - Year 4

- 07** SHOPPING CENTRE AND RETREAT
Architecture Design Studio - Year 4
- 08** PAWNA PROJECT
Internship - RH(a+d)
- 09** ARCHITECT'S ARENA
International Design Competition by
Archmello

01 THE MODEL DETAIL

STUDIO - MSDAAD SPRING SEM

Programme : Theatre and Performance Space

Mentor : Carl D'Apolito-Dworkin

Site : East Boston Waterfront

In collaboration with : Krisha Mody

The studio challenged us to use model-making as a tool for architectural experimentation. The brief asked us to first generate complex geometries through mathematical equations and computational design, and then translate them into physical models using fabrication techniques.

We chose the Enneper surface for its spatial potential and curvature. Through iterative testing and panelization, we explored how it could inform architectural systems. In the second phase, we reimagined the fabricated form as a building—designing a contemporary theatre.

Set in Boston, the project responds to its cultural context by merging performance and public space. The Enneper's curves shape circulation, structure, and acoustics, creating a spatially immersive theatre where architecture and performance are tightly intertwined.

GEOMETRY EXPLORATION OF DOUBLY CURVED SURFACES

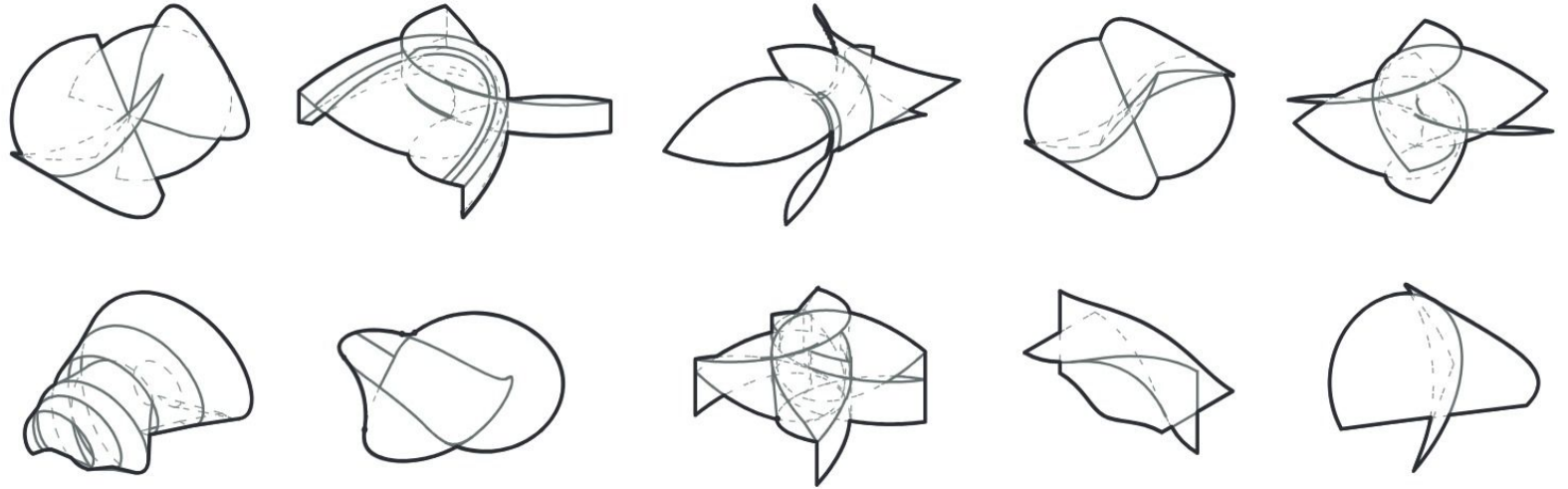

IDEA FOR FORM FORMATION - OFFSET SHELL

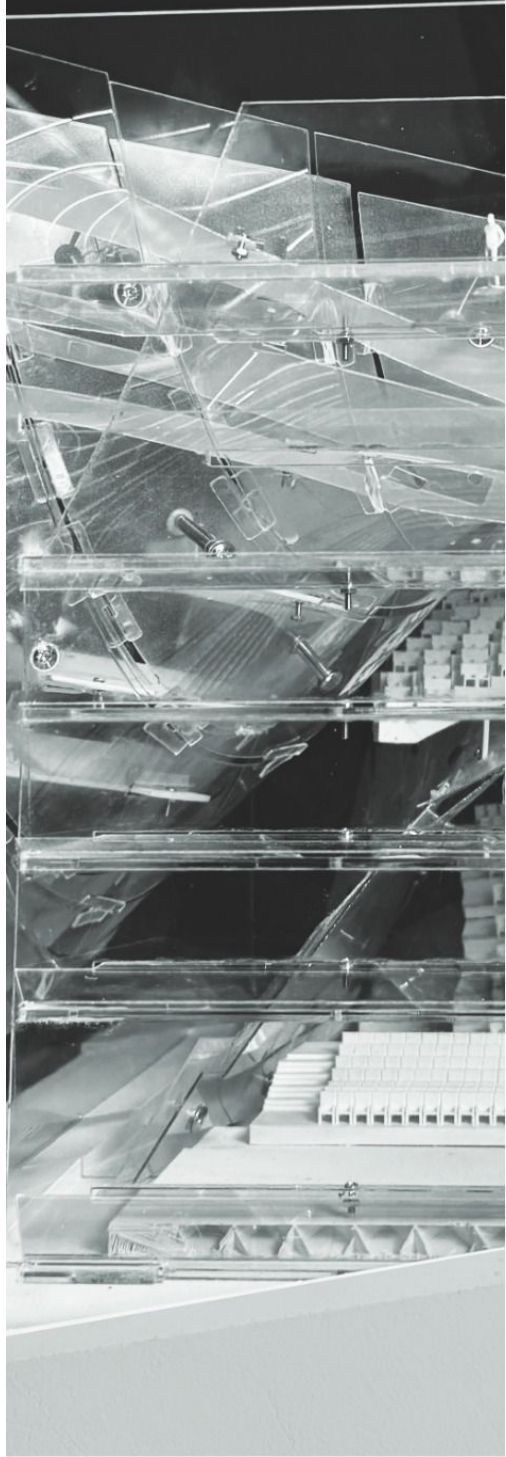
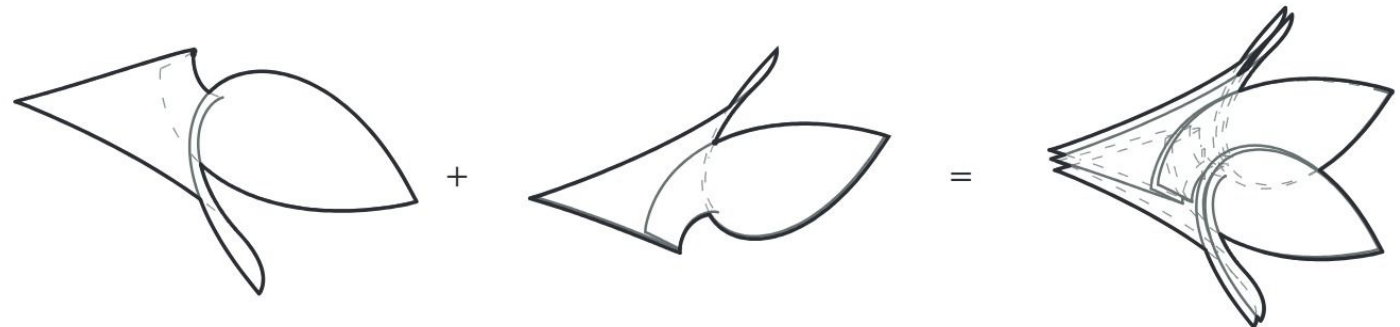

MATERIAL TESTS

Single layer panelised enneper

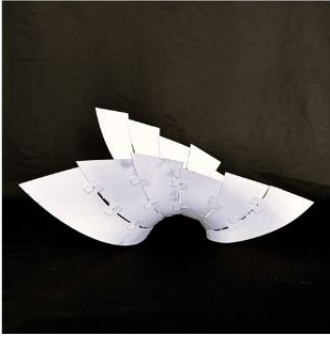

2 layers on top



Offset Shell - Staggered layers

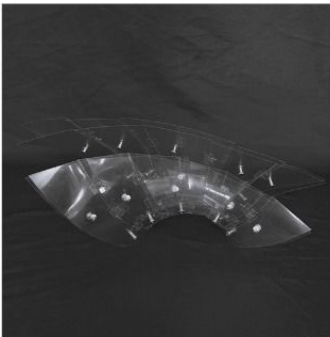

Four layers of two offset shells

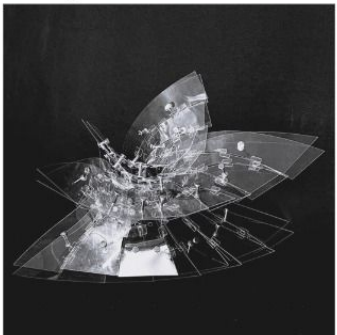

PANELIZATION + STRUCTURAL STRATEGY

Layer 1 & 2

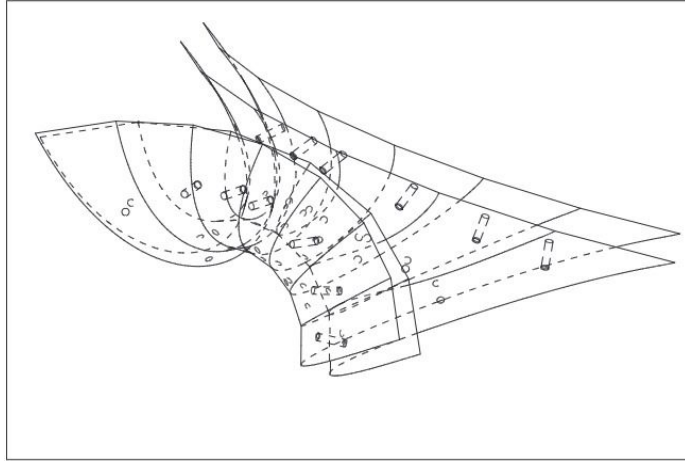

Layer 3 & 4

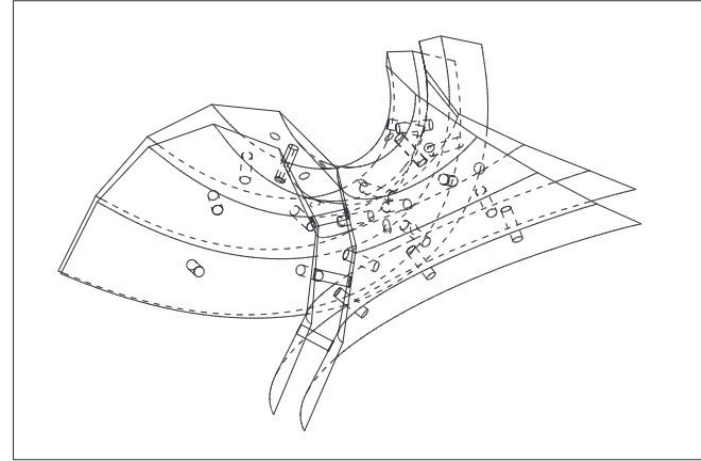

Layer 2 & 3

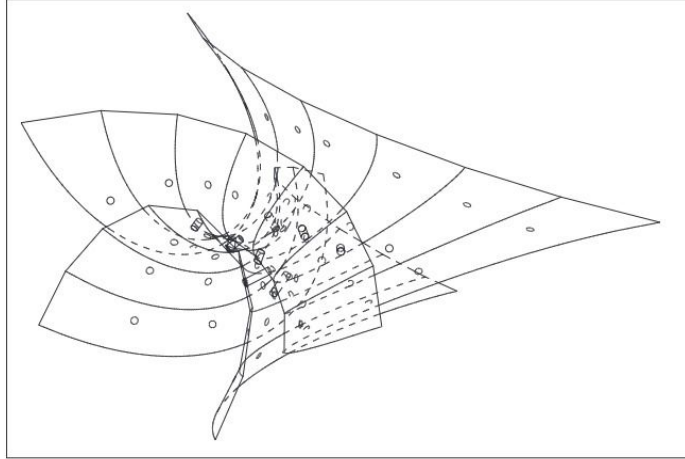

All layers

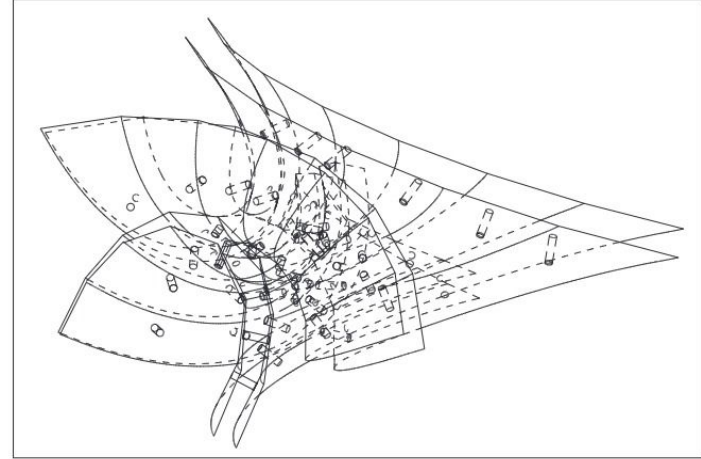

This system utilizes a double-layered Enneper surface, panelized into developable strips for ease of fabrication. The strips are staggered across overlapping layers to prevent direct alignment of joints, enhancing both durability and flexibility. Layers are fastened together at key points, forming a continuous, unified surface.

The curvature of each strip adds structural stiffness, while tension bands lock the geometry in place. Overlapping layers act as both environmental shielding and structural reinforcement. The self-intersecting nature of the Enneper form further contributes to rigidity, allowing the surface to behave as a lightweight, frameless shell.

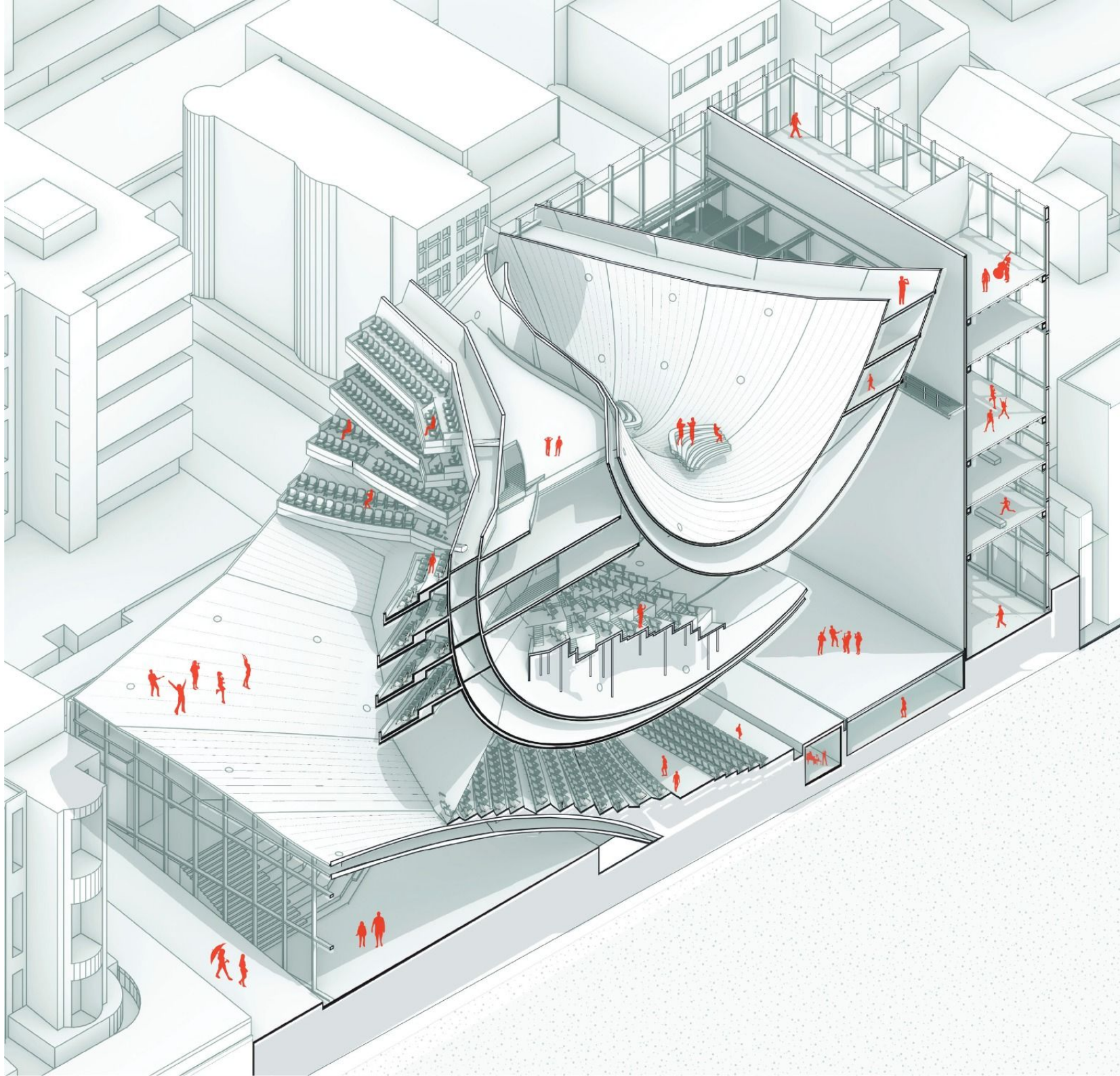

Set within the dense urban fabric, the building embeds itself into the block while carving out a public space and maintaining visual and spatial porosity. The Enneper surface becomes the project's core spatial device—dividing, connecting, and supporting varied audience experiences across both interior and exterior theatres. The building is sectionally layered to host distinct programs—performance spaces, backstage functions, circulation zones—while remaining visually continuous across floors.

Strategically placed openings in the form and façade allow sightlines between audience and performer, interior and city. The thickened wall zones house catwalks, exits, and backstage access, dissolving the boundary between performance and support spaces. The rooftop acts as an urban park, offering partial views into the theatre and aligning with the site's broader civic intent—turning the building into both a stage and a spectator in the city.

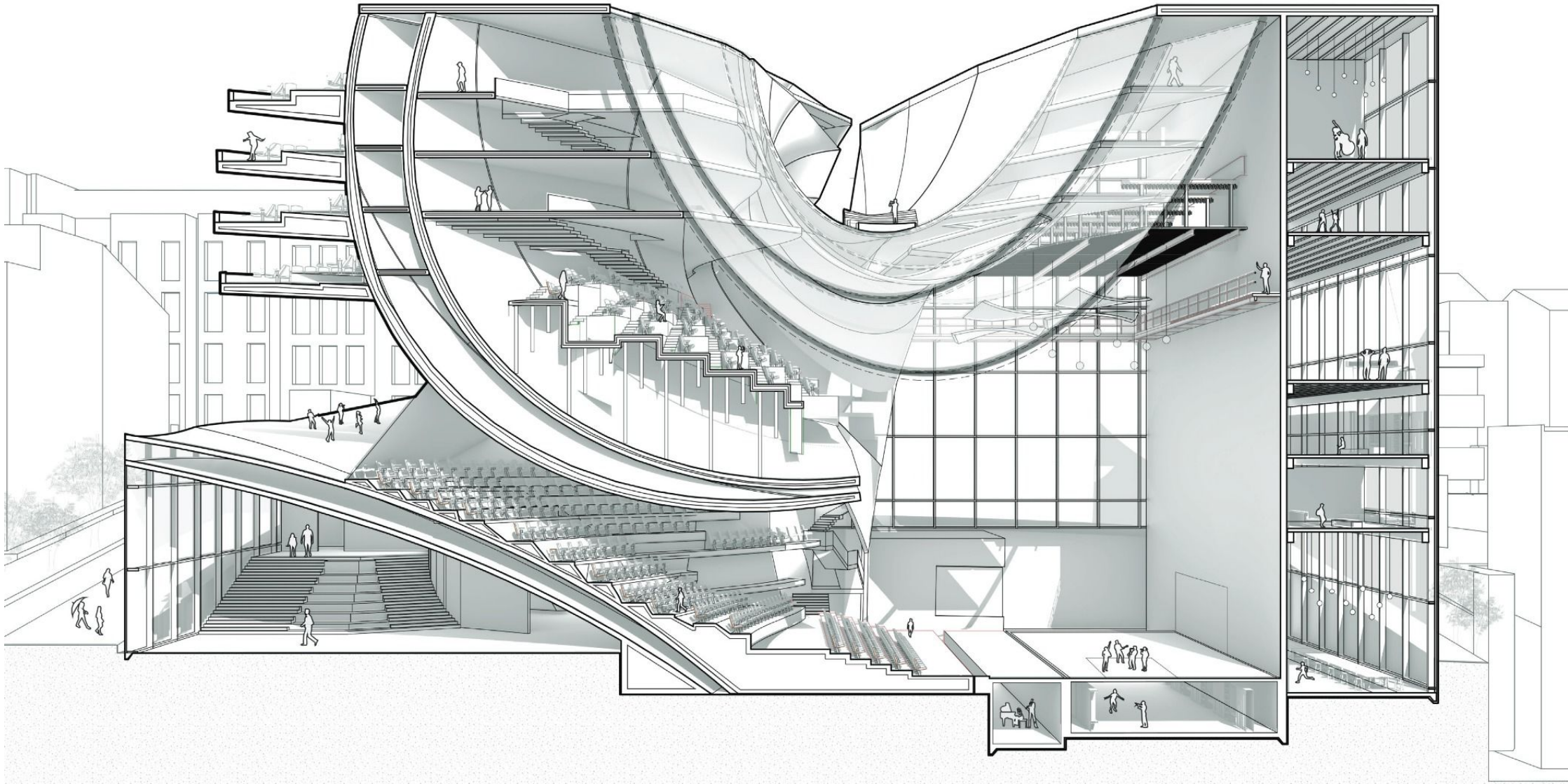

SECTION PERSPECTIVE LOOKING FROM WEST

This sectional perspective highlights the spatial and performative logic of the project. The Enneper surface shapes the seating, balconies, and ceiling, while the thickened wall poche becomes a programmatic zone—hosting exits, catwalks, and backstage circulation. This wall blurs front and back of house, acting as a transparent, inhabitable threshold.

The section also reveals the fluid connection between interior and exterior theatres, allowing performances to extend across spaces and audiences to move freely—redefining passive spectatorship.

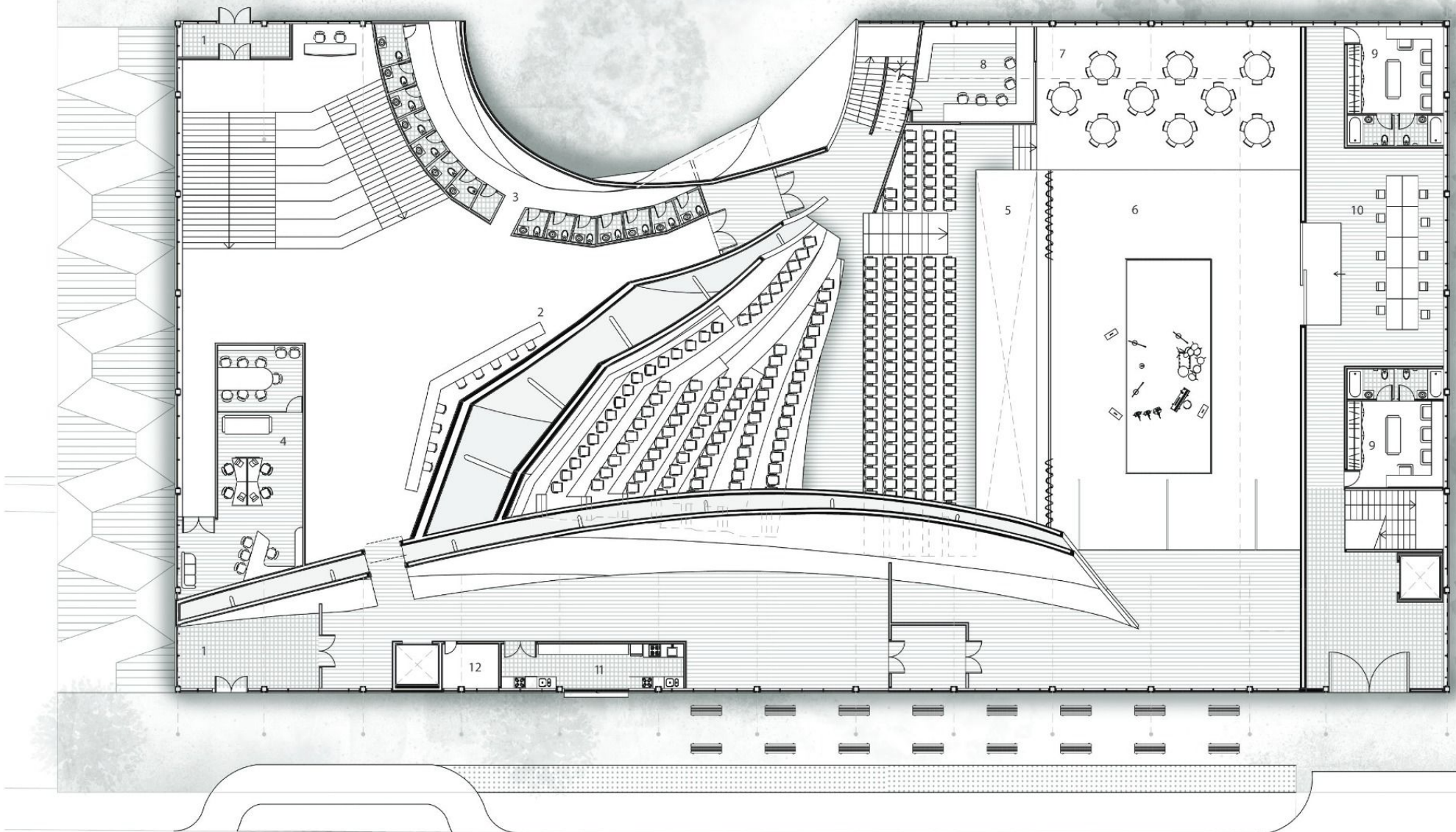

GROUND FLOOR PLAN

The ground floor is organized into three zones: entry, theatre, and back-of-house. Visitors first encounter the sweeping Enneper overhead before moving through a compressed threshold into the main theatre. The wall poche serves as a porous boundary, integrating circulation, exits, and technical space while visually linking backstage and audience zones. The cabaret seating under the surface enhances immersion, while the stepped form begins to open the building toward the adjacent public plaza.

- | | | | |
|---|-----------------|----|-----------------|
| 1 | Entrance | 7 | Cabaret Seating |
| 2 | Reception Lobby | 8 | Monitor Room |
| 3 | Restrooms | 9 | Green Room |
| 4 | Administration | 10 | Prop Shop |
| 5 | Orchestra Pit | 11 | Kitchen |
| 6 | Stage | 12 | Mechanical Room |

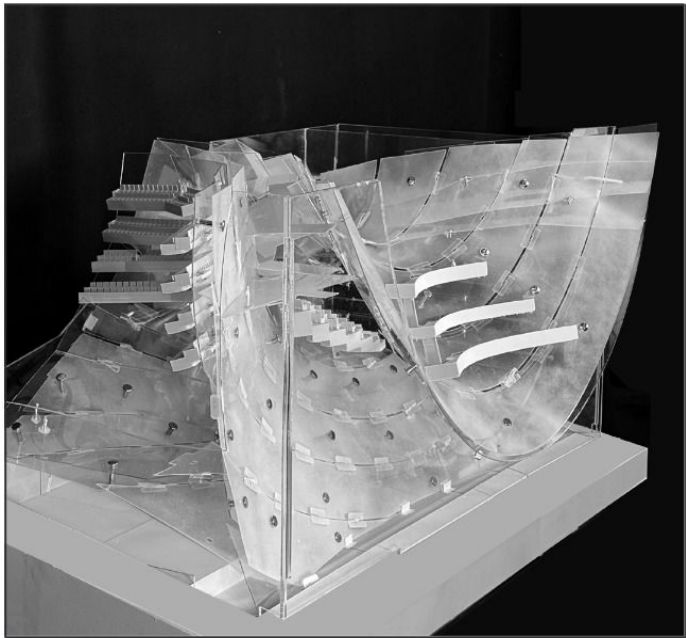
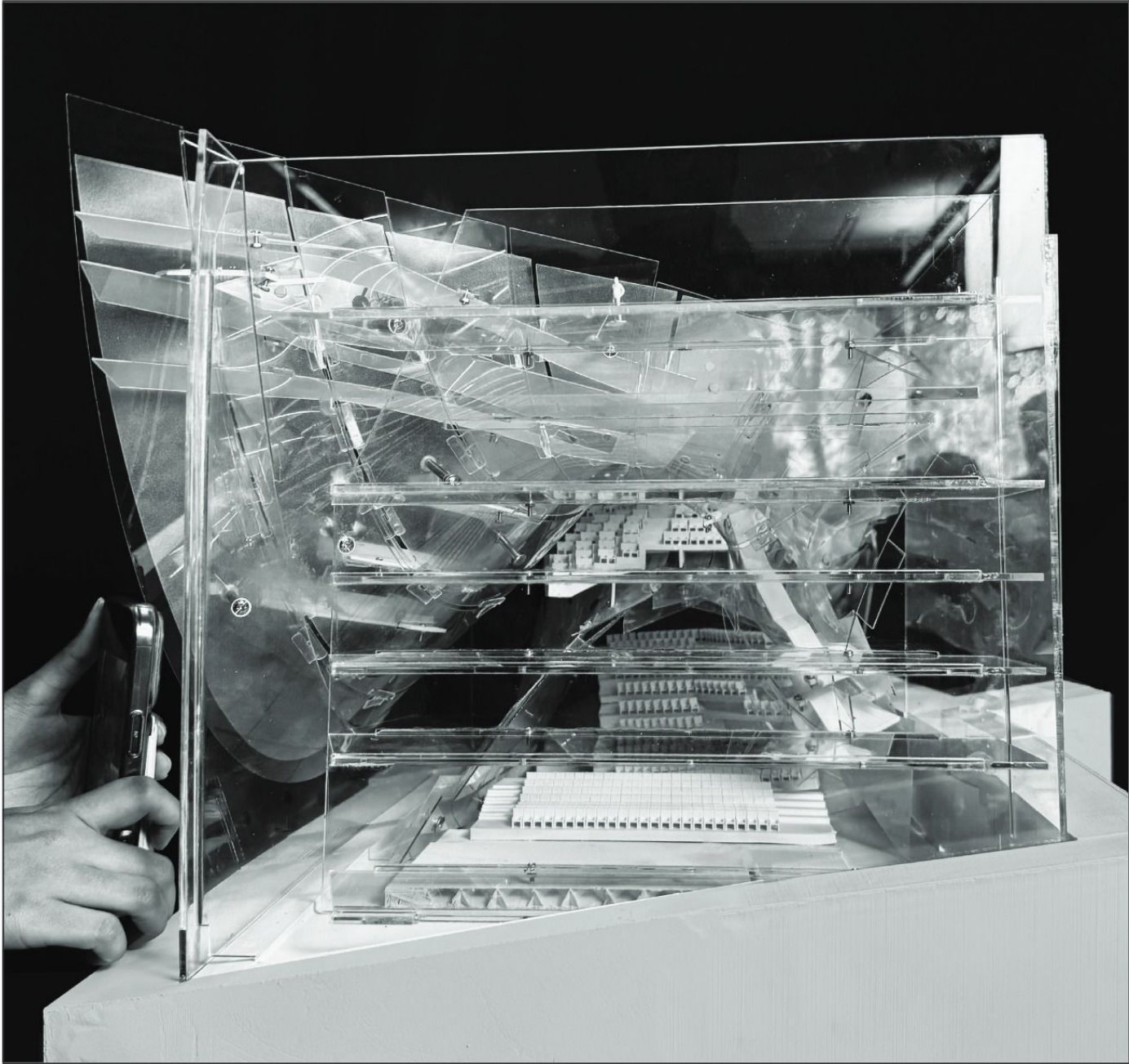

MODEL PHOTOS

1:100 Scale

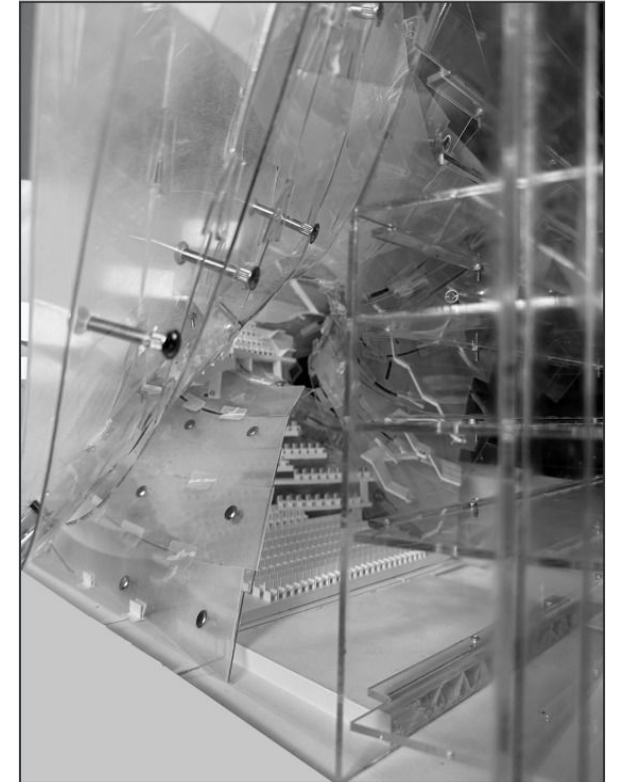
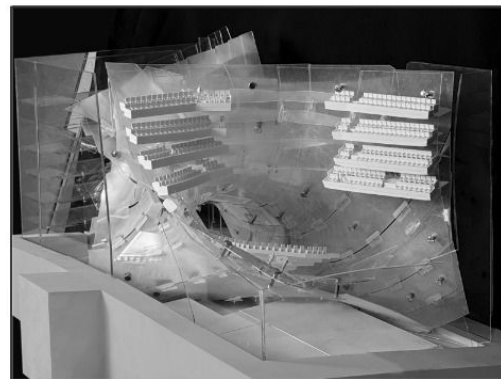
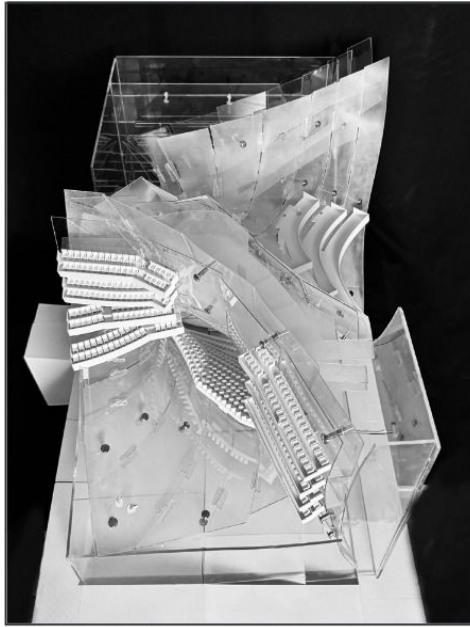

MODEL PHOTOS
Showing Interior Views

02 OFFICE ASSET BUILDINGS

STUDIO - MSDAAD FALL SEM

Programme : Casino and Vertical Farming

Mentor : Ar. Fabian Llonch

Site : 500 Park Avenue, New York

This studio explores the potential of adaptive reuse to transform underperforming office buildings in New York City, addressing post-pandemic economic shifts and sustaining the city's global financial prominence.

The process includes analyzing iconic sites such as the Corbin Building, 80 Maiden Lane, and the Pepsi-Cola Building to uncover opportunities for blending architectural heritage with modern functionality. Proposals will integrate precedent studies, hybrid model development, and speculative programming to reimagine these structures as sustainable, economically productive assets.

The goal is to craft visionary designs that not only preserve and enhance the cultural significance of these sites but also contribute to the economic and architectural vitality of New York City, fostering local growth and reinforcing its global relevance.

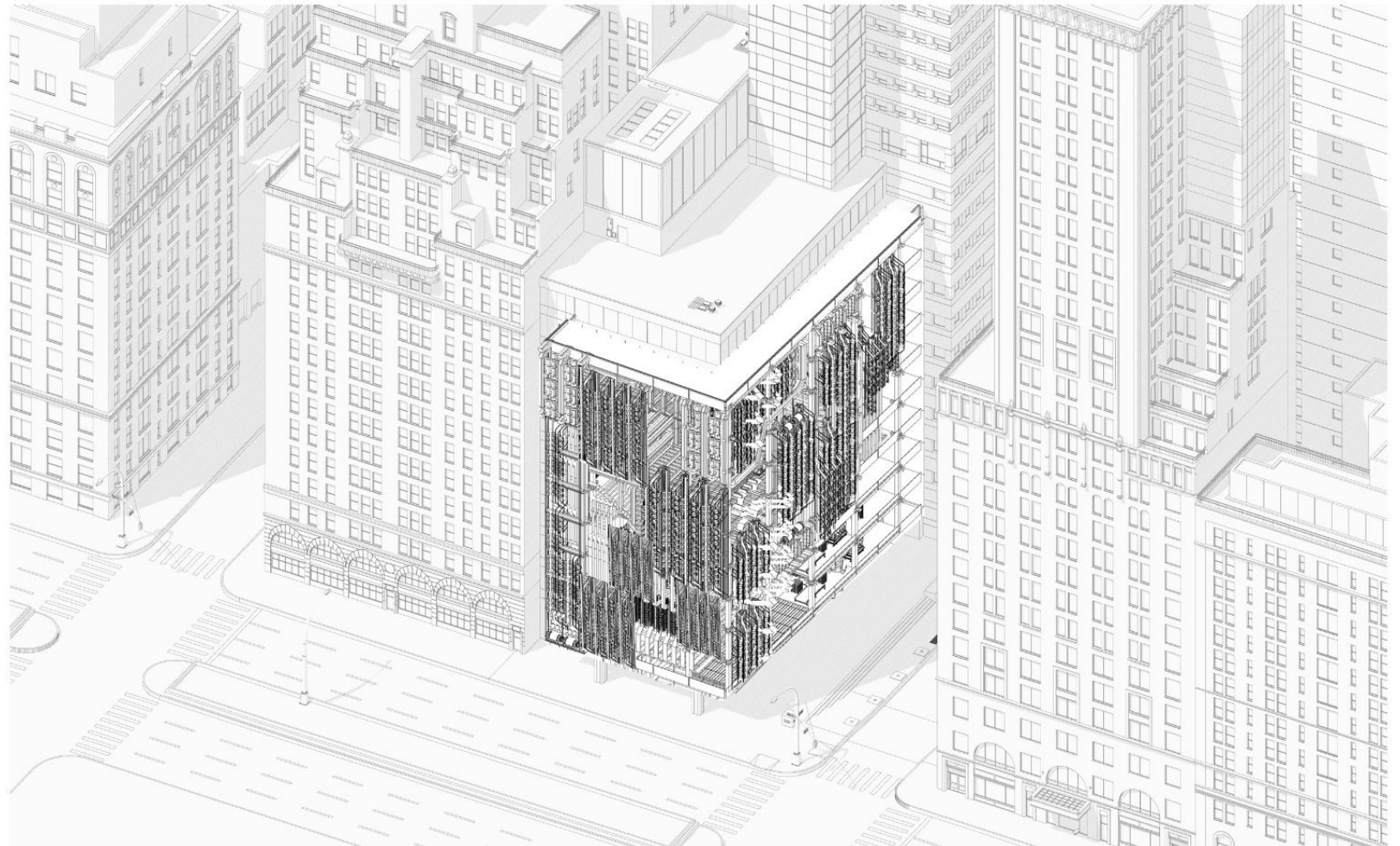

MODEL ON SITE

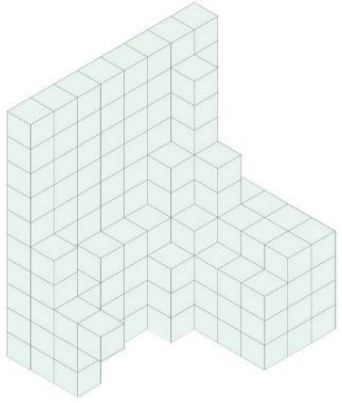

VERTICAL FARMING CENTRE

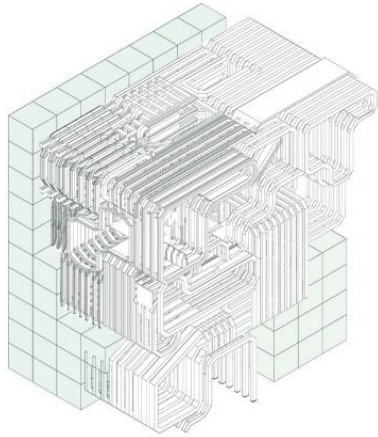

CASINO MASSING ON VF

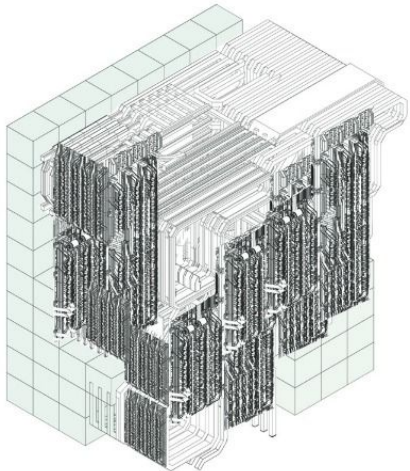

VERTICAL FARMING ON FACADE

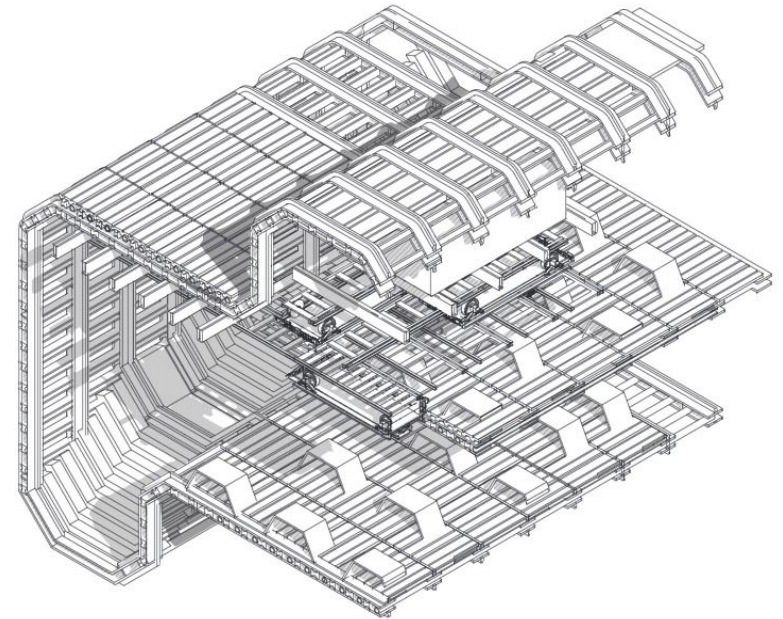
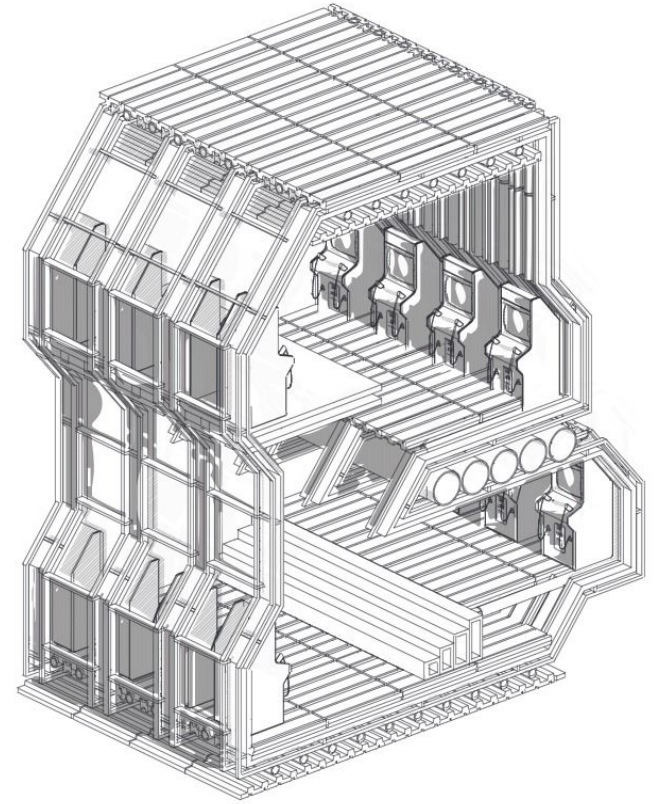
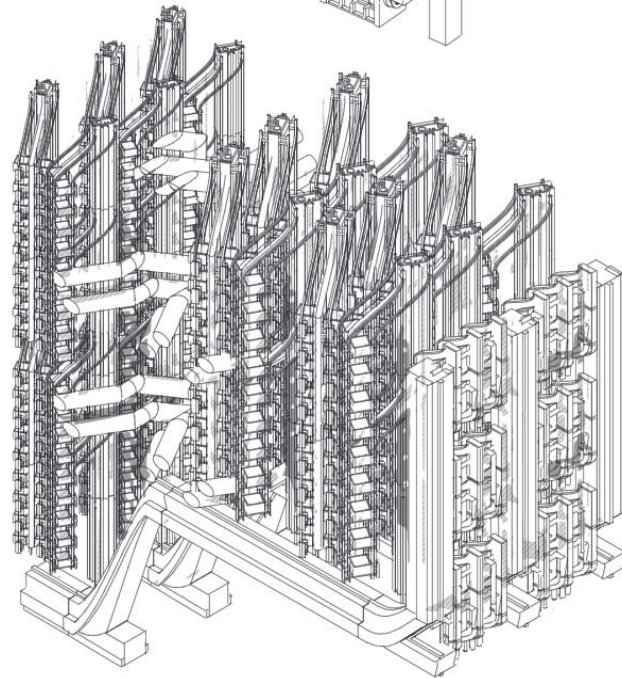
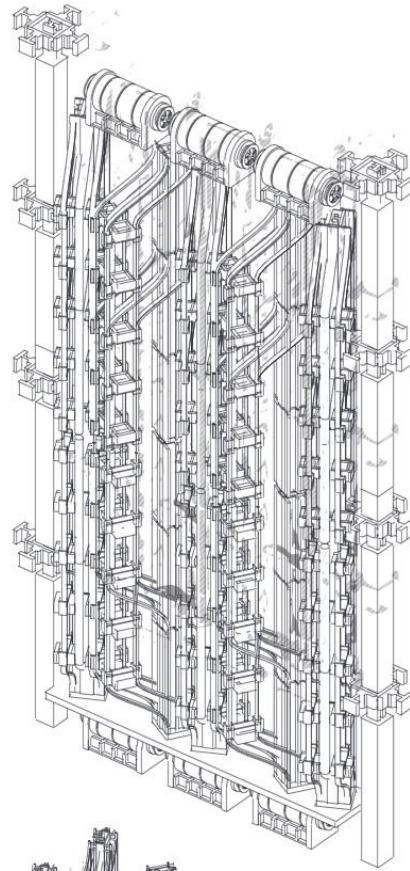

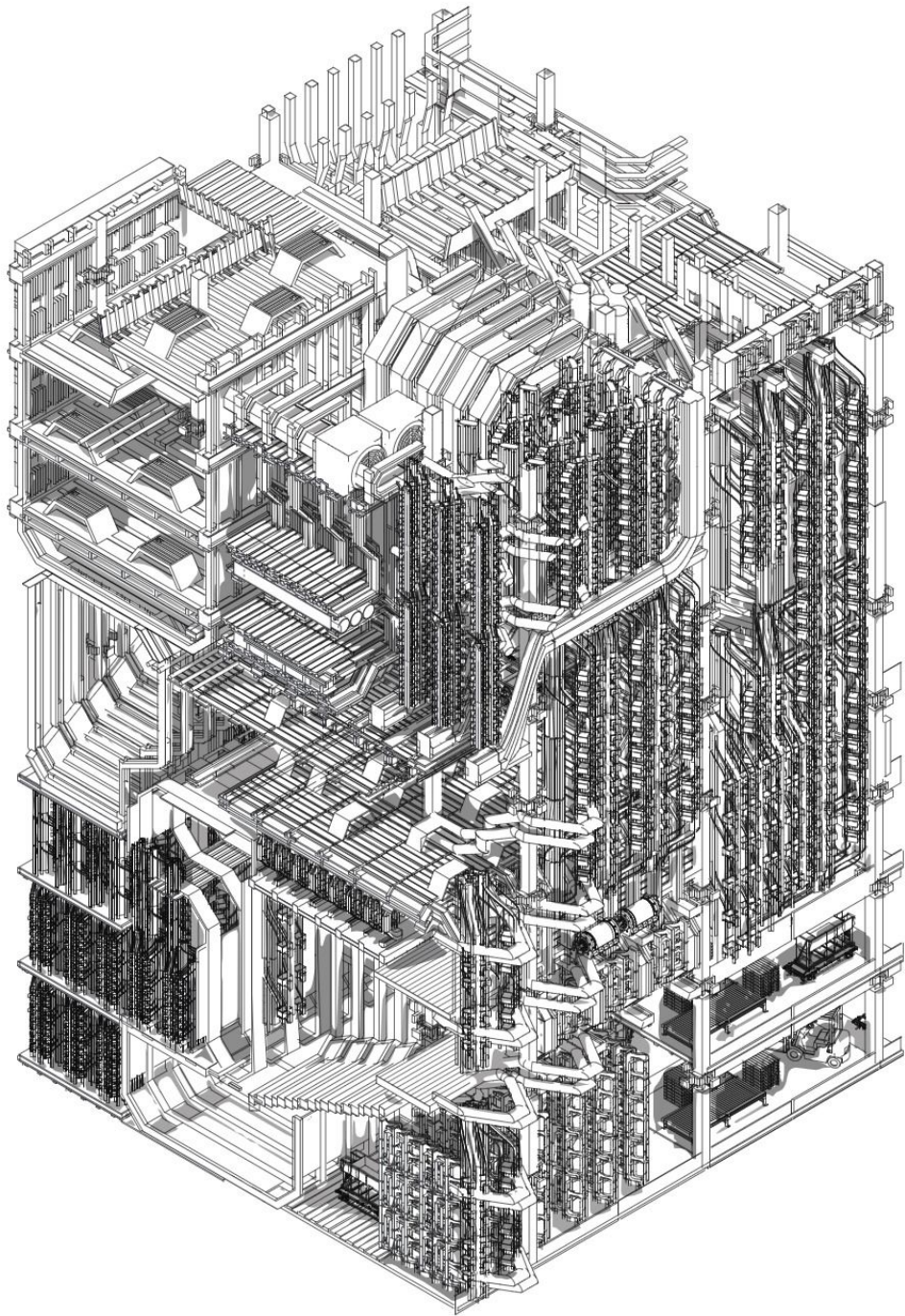

AXONOMETRIC SECTION

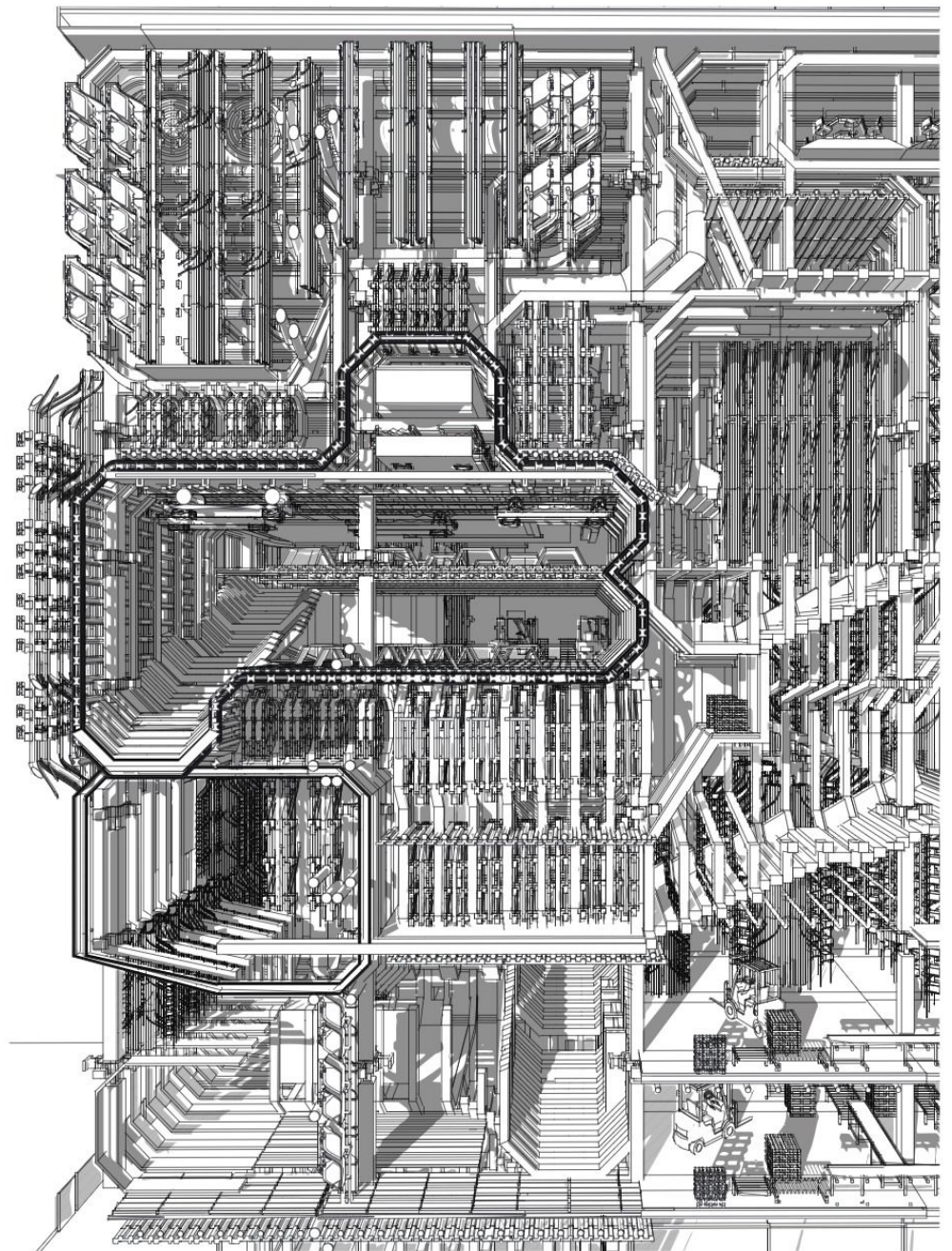

SECTION PERSPECTIVE

PHYSICAL MODEL

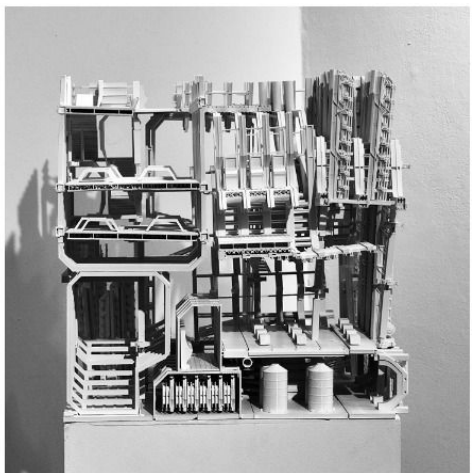
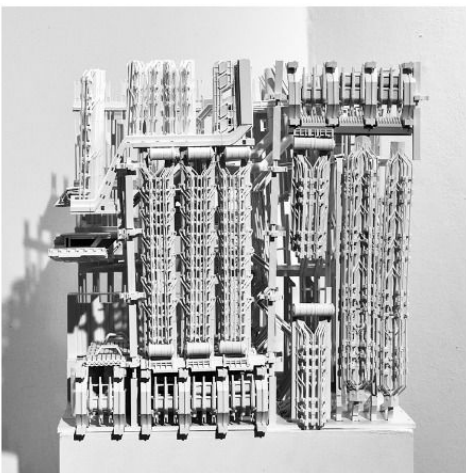
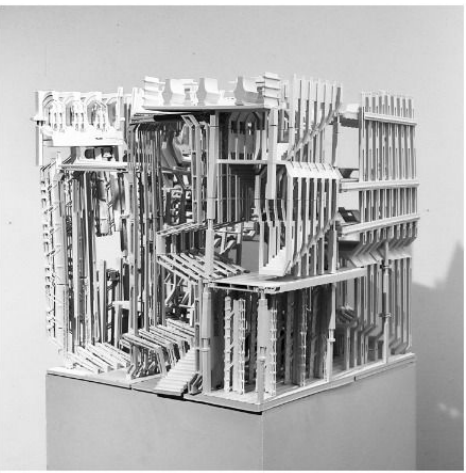
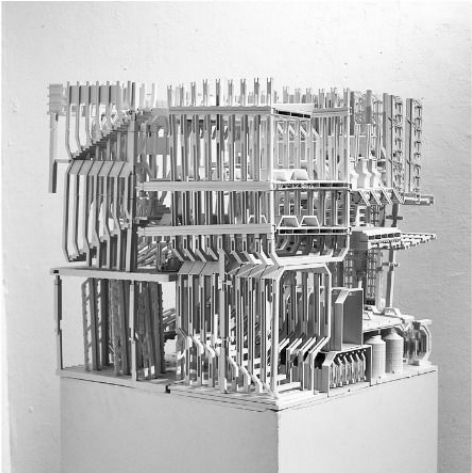
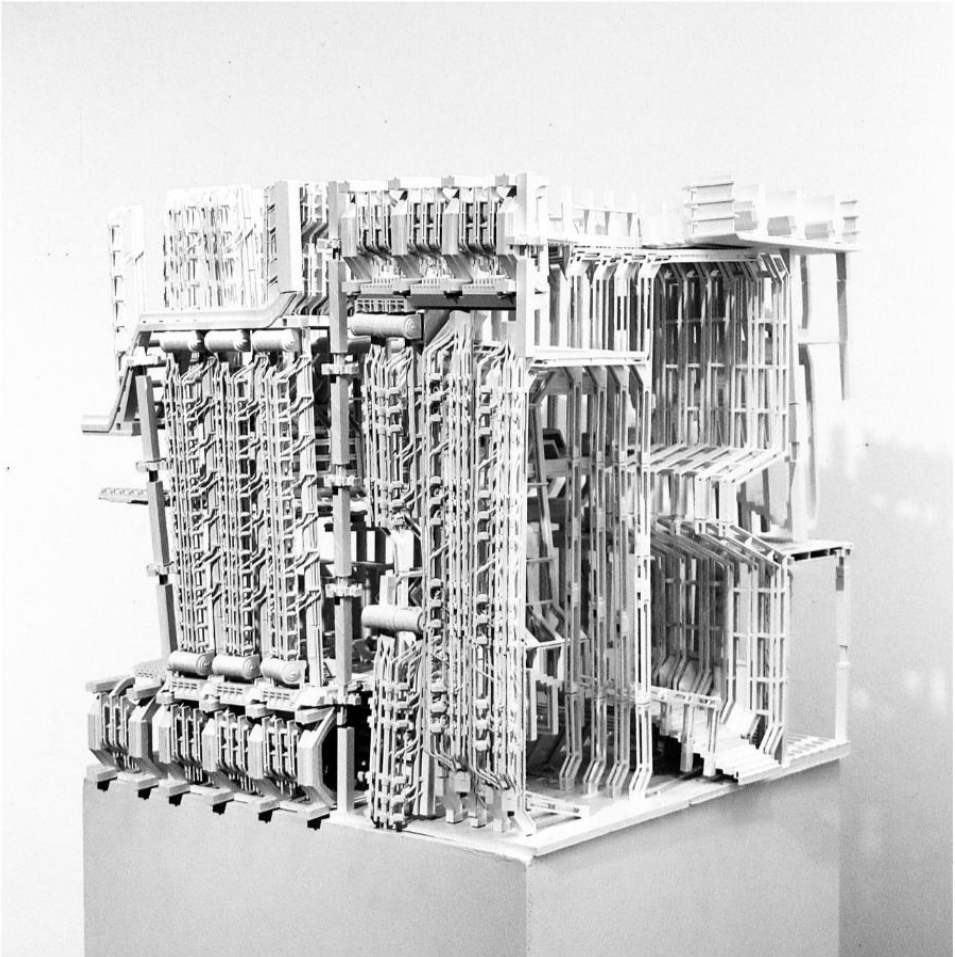
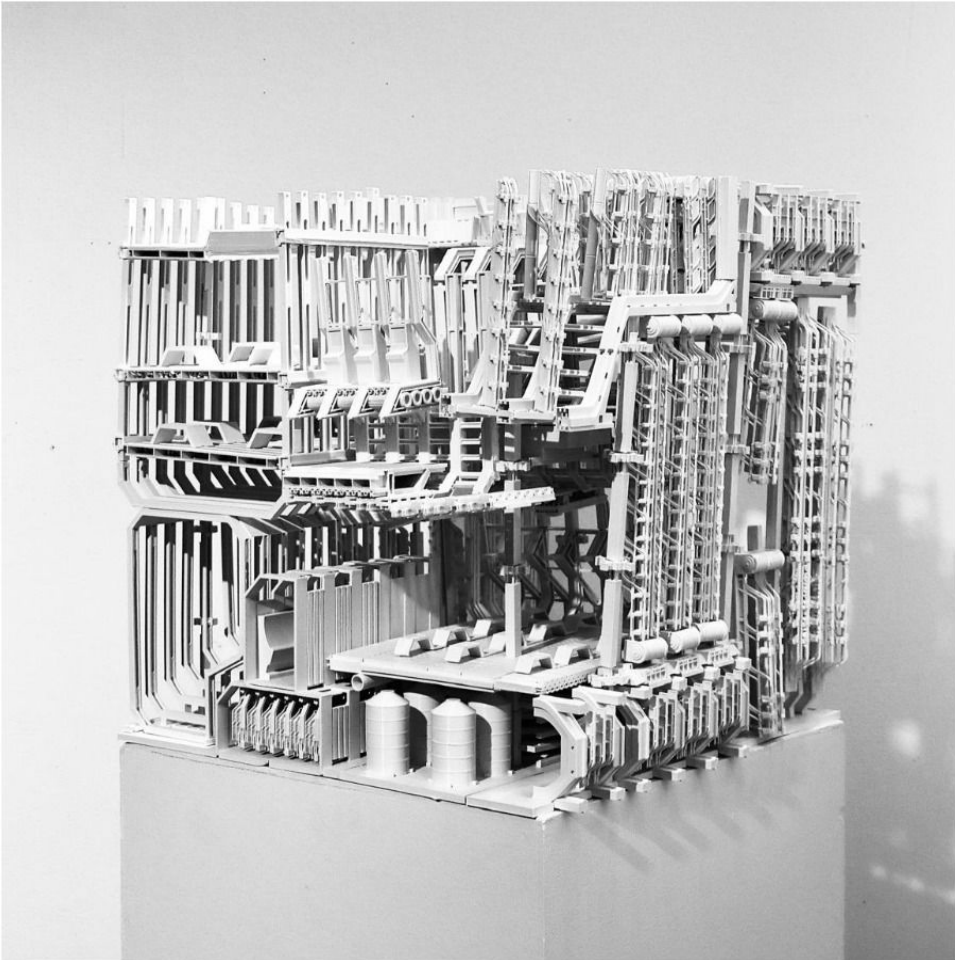

CONSTRUCTION & EMPATHY

STUDIO - MSDAAD FABRICATION SEM

Programme: Residential envelope design exploration

Mentor: Prof. Andrew Holder

Site: Mount Washington, Los Angeles

The aim of this studio was to investigate the wall as both a physical and conceptual construct—understood not as a static boundary, but as a dynamic assembly of forces, parts, and spatial relationships.

The project approaches the exterior wall of the American house as a complex system of simple machines, revealing and amplifying the hidden physicality within its framing, cladding, and connections.

The goal is to engage with this dynamism through three strategies: altering the wall's relationship to gravity, rethinking the standard kit of parts via custom-fabricated components, and adjusting the inside–outside binary to propose novel expressions for surface, openings, and organization.

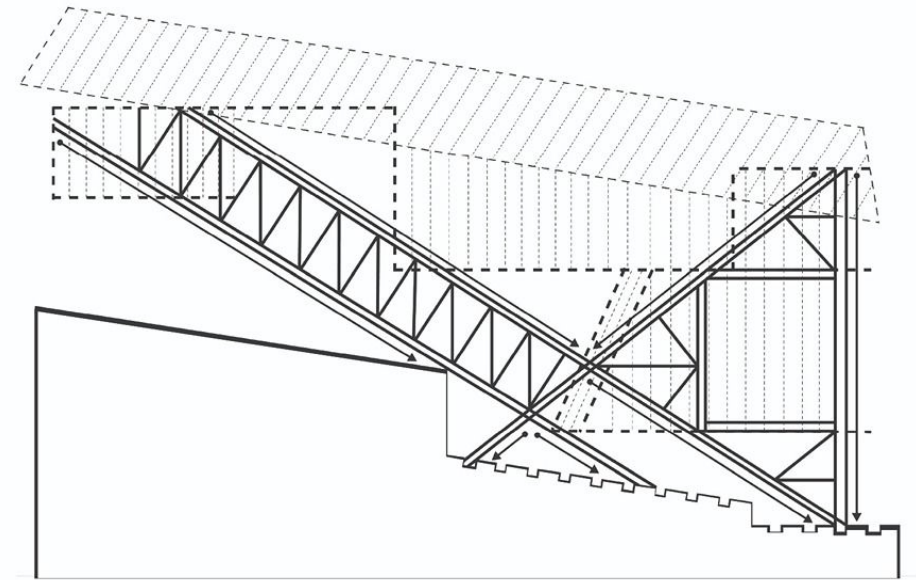
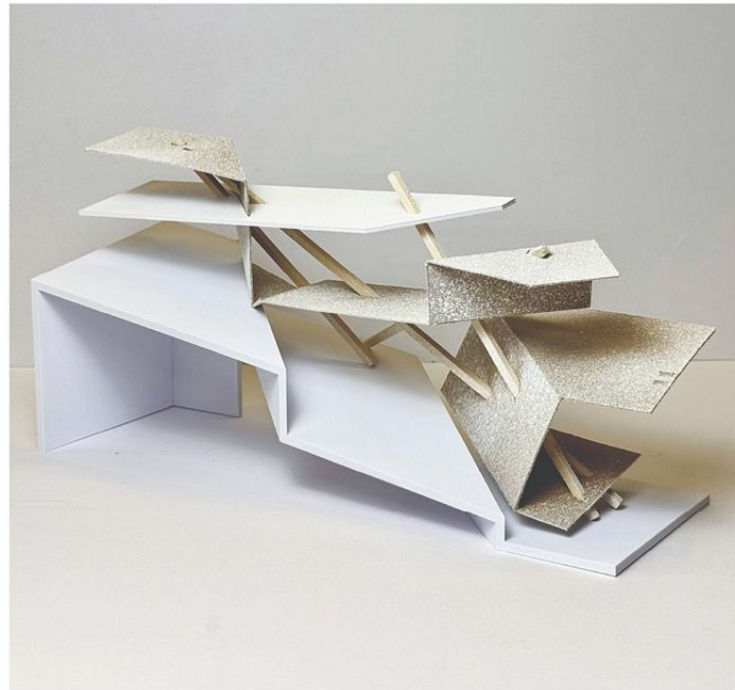

The structural approach originated from a found-object model, establishing the relationship between folded surfaces and linear elements. Folded plates are intersected by rods, each passing through a surface at least twice for stability. Force diagrams tested load distribution and validated the geometry.

A rotated-attic truss on the right anchors one primary space, with a secondary wall system supporting two more. These components form a clear structural hierarchy that organizes the load path while preserving the spatial and formal intent of the concept model.

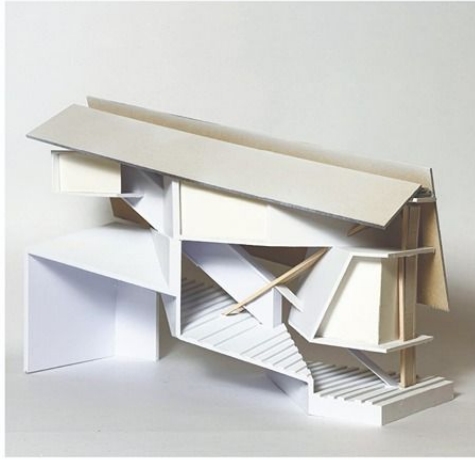

Sectional Details

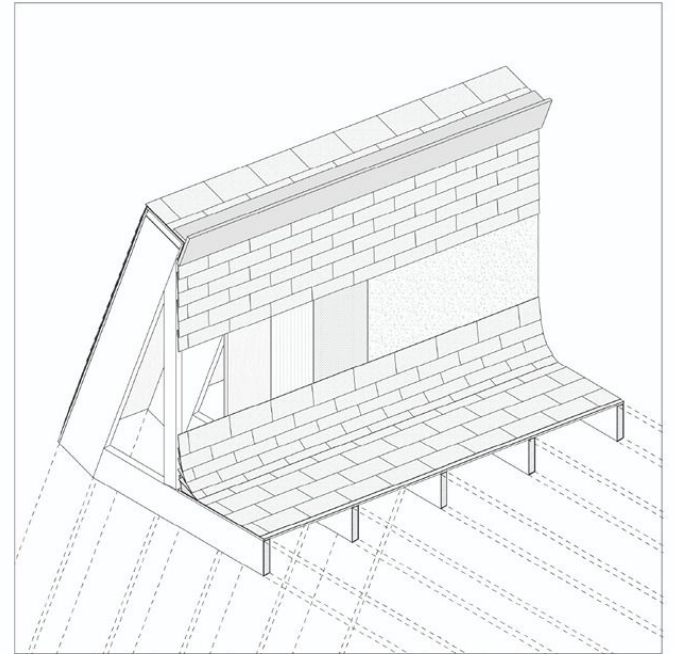
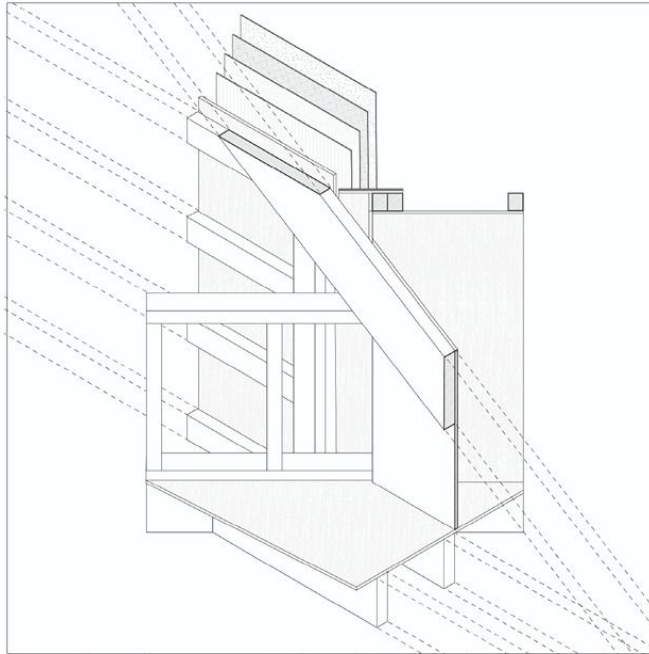
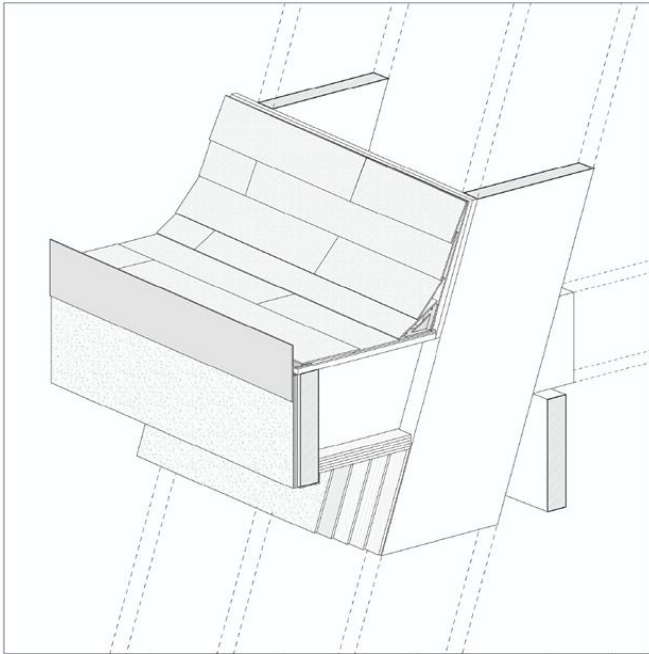

Cut Plan

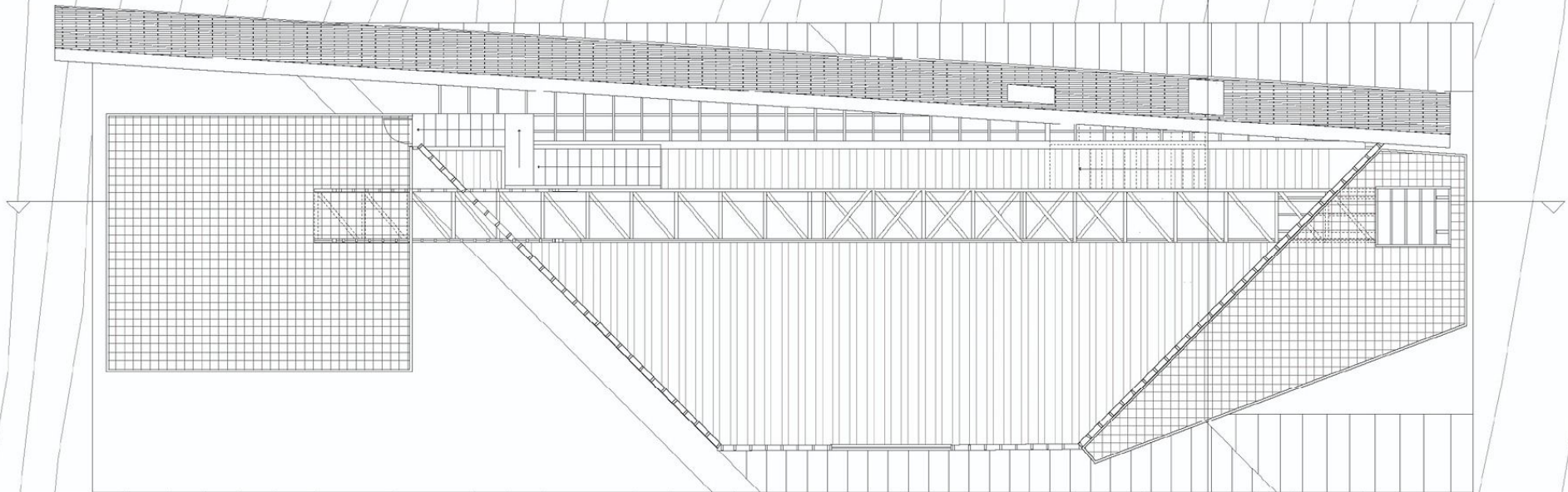

Worm's eye

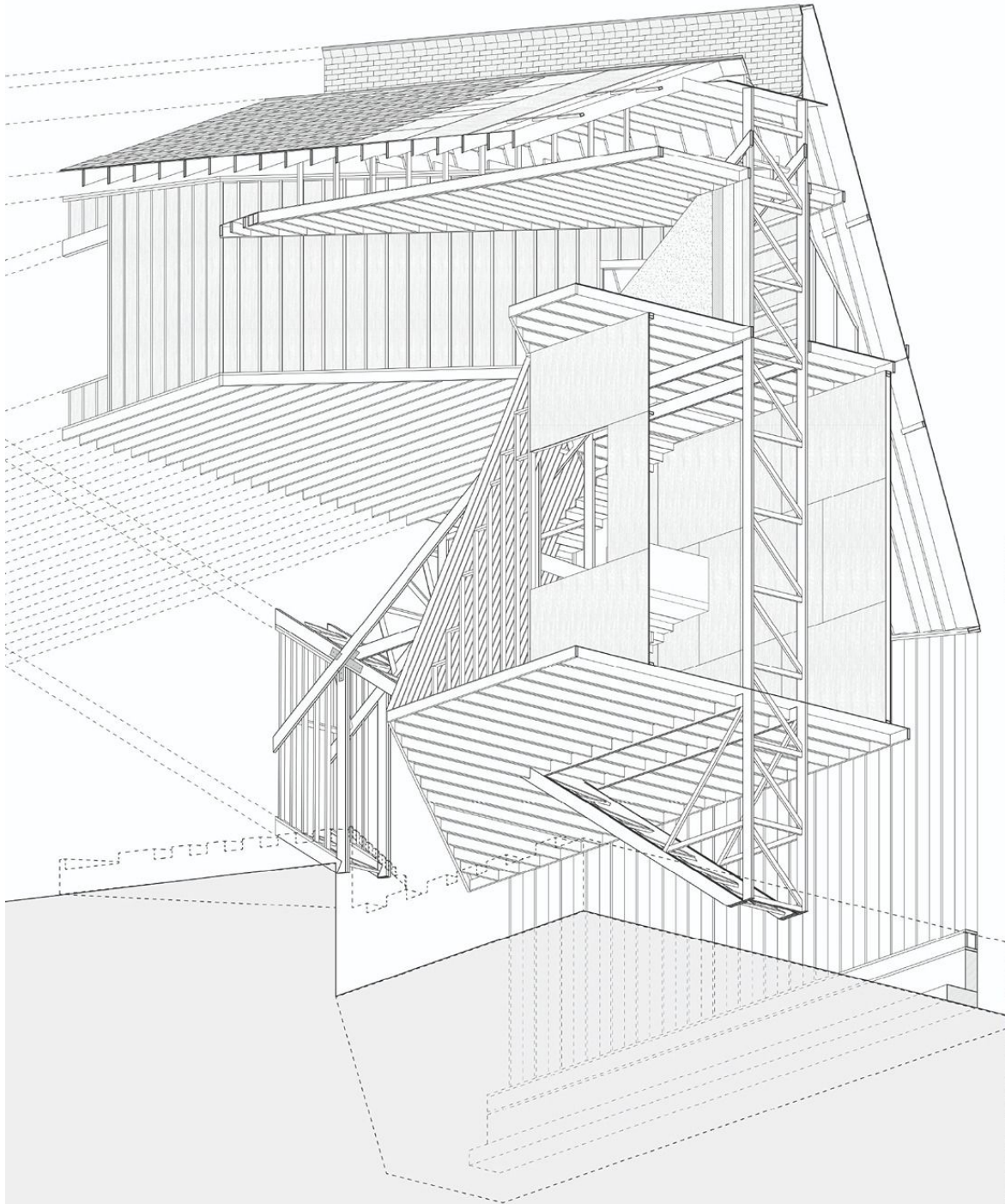

Long Section

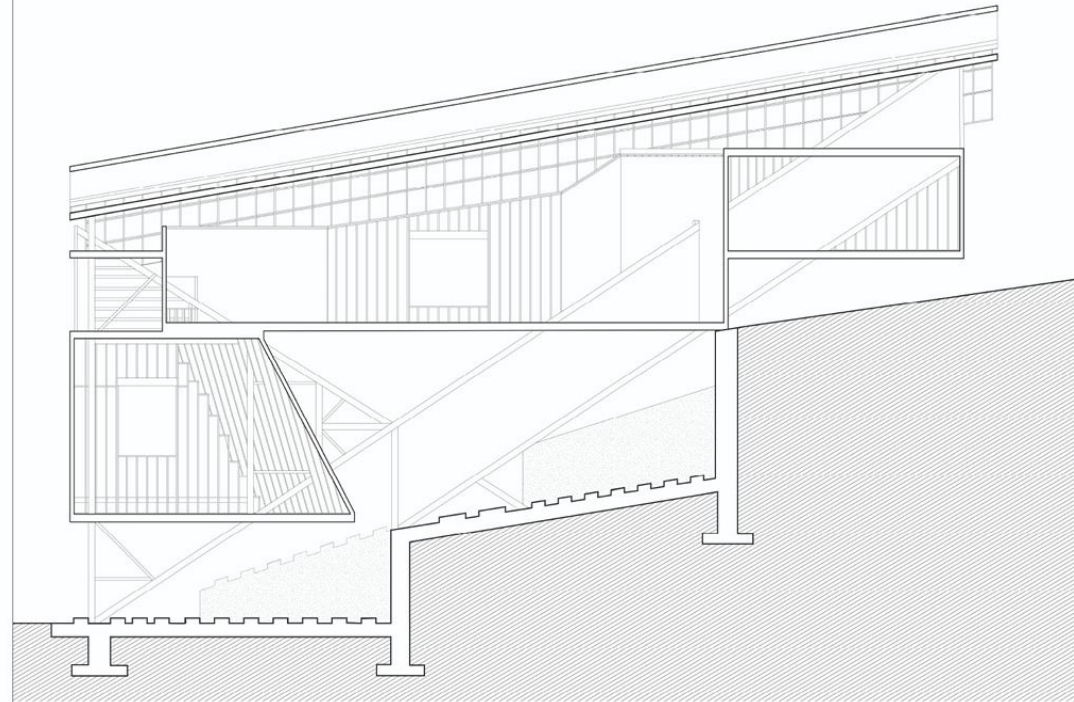

Short Section

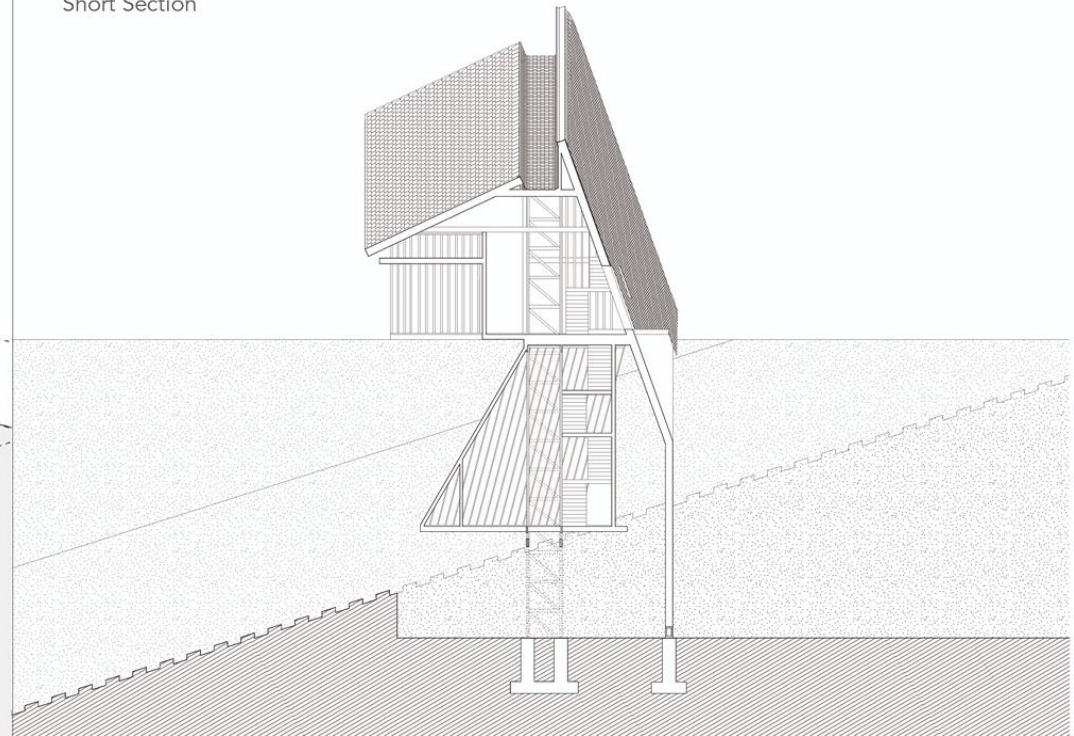

03 IMPACT AESTHETICS

DESIGN INNOVATION

Programme : Facade Elevation

Mentor : Ar. Hina Jamelle
hina.jamelle@c-a-p.net

The Design Innovation seminar investigates the intersection of cultural progression, digital techniques, and contemporary aesthetics to redefine architectural practices. Emphasizing the role of innovation in shaping and responding to cultural and technological shifts, the course explores the impact of advanced design techniques on the evolution of architectural details.

Participants develop a buildable façade using cutting-edge digital tools and manufacturing methods, culminating in a 3D-printed model. Through readings, discussions, and iterative design processes, the seminar emphasizes the relationship between culture, aesthetics, and technical advancements, fostering an understanding of how architecture can continually innovate to remain culturally and aesthetically relevant.

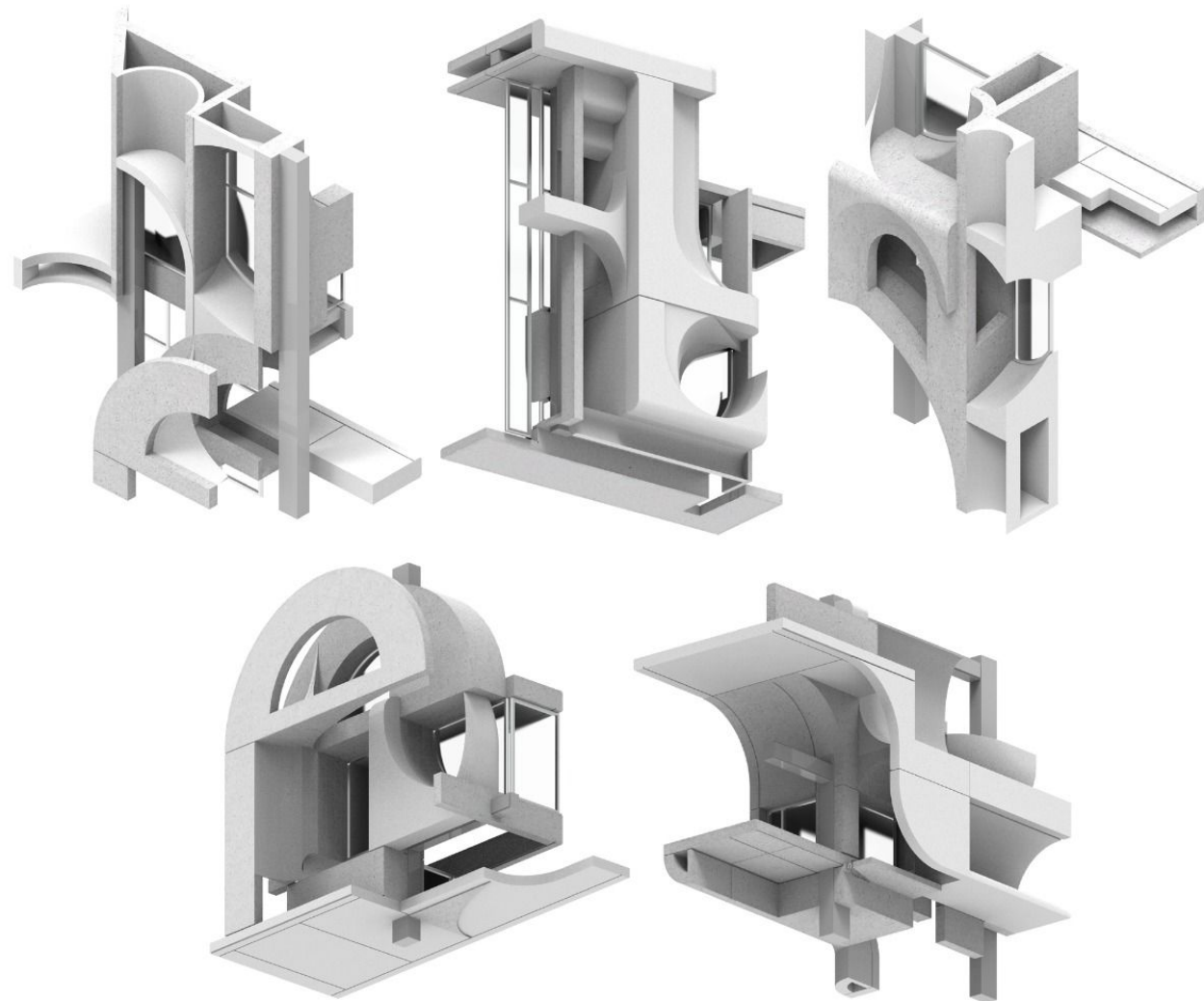

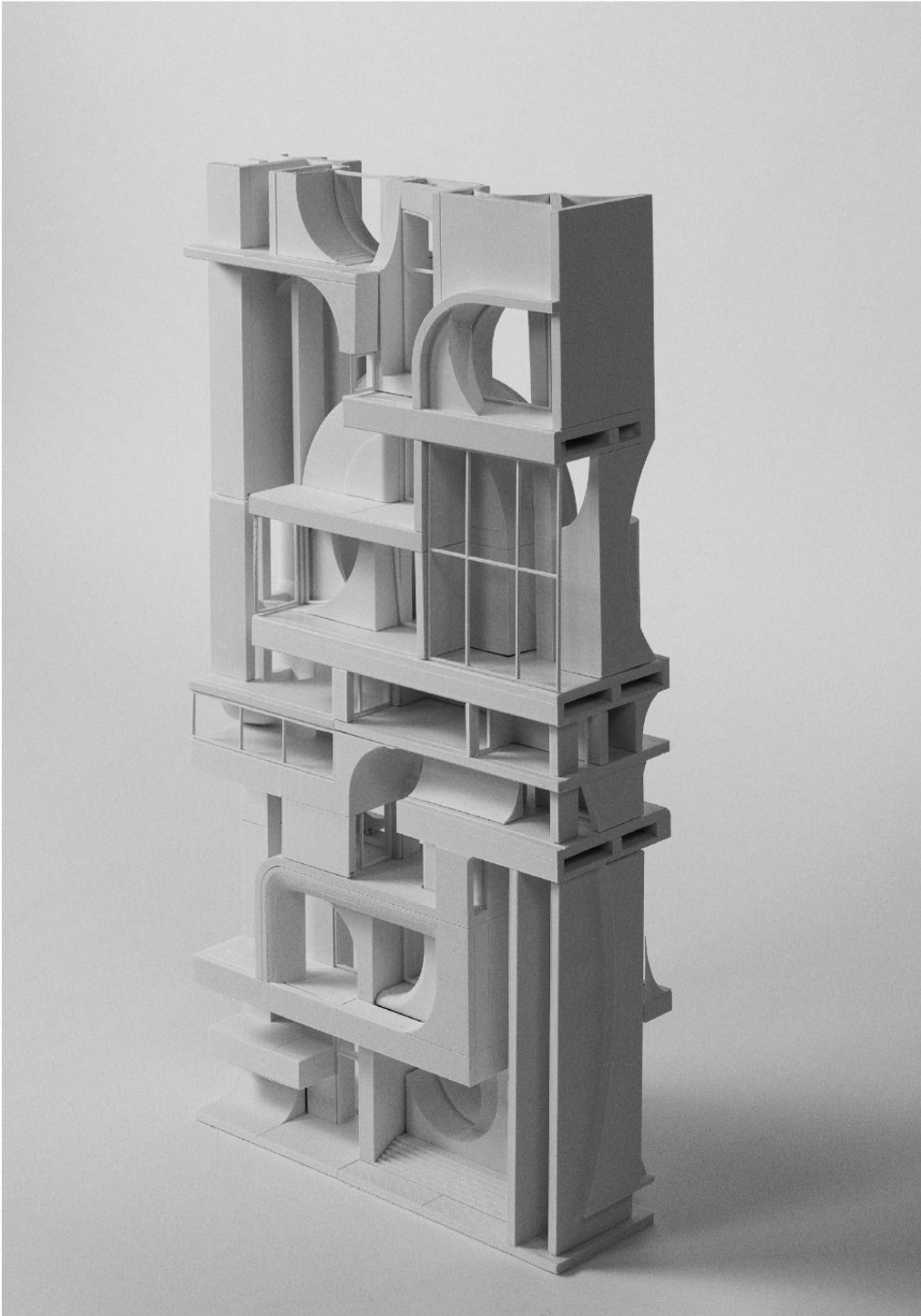
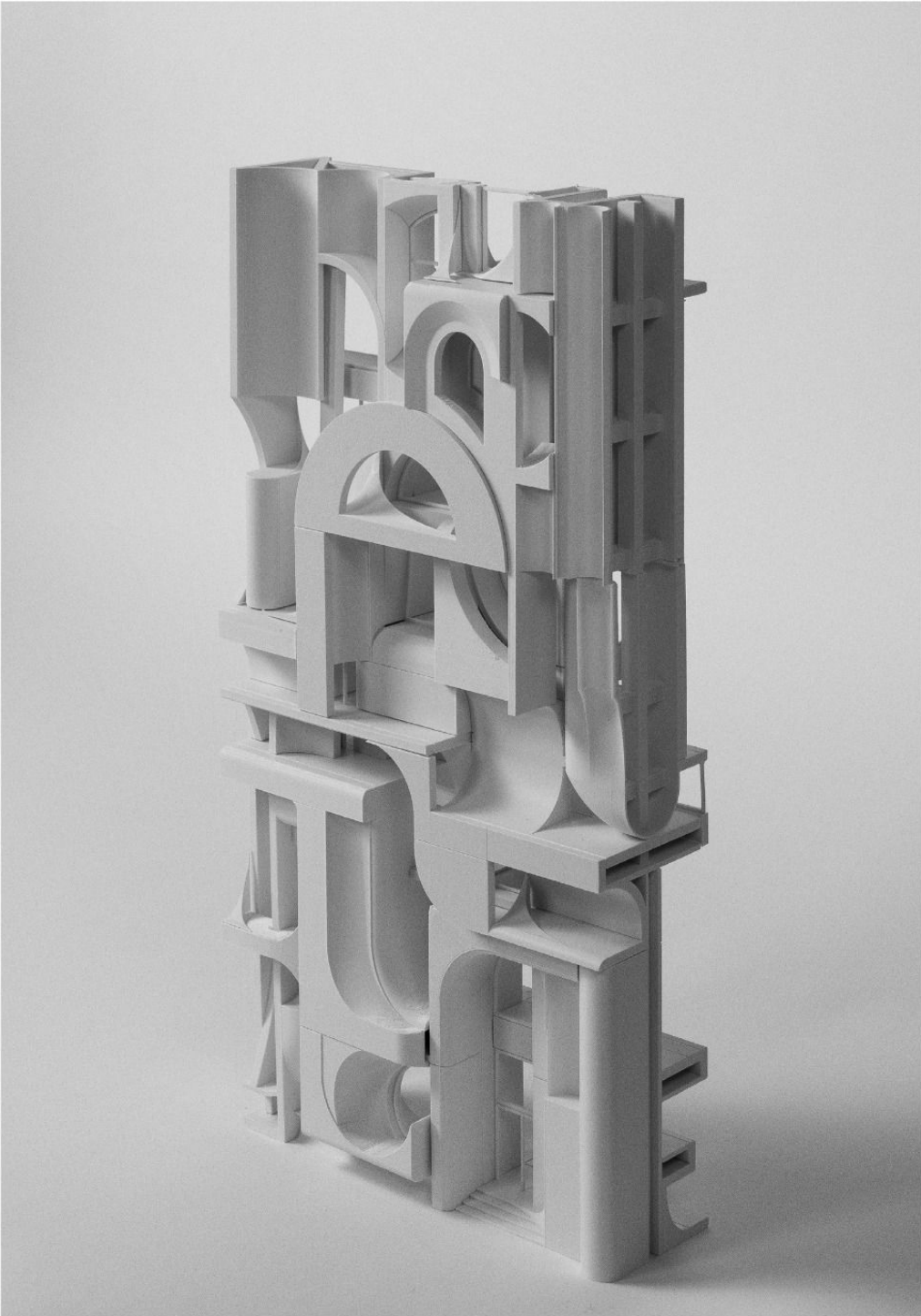

PHYSICAL MODEL

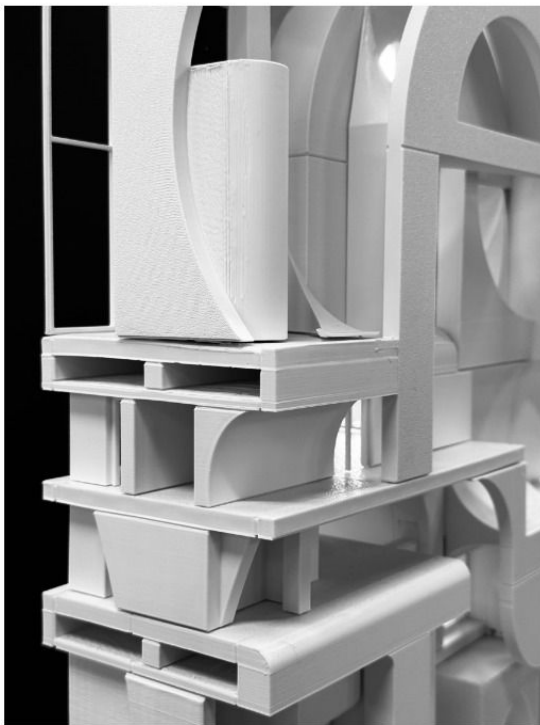
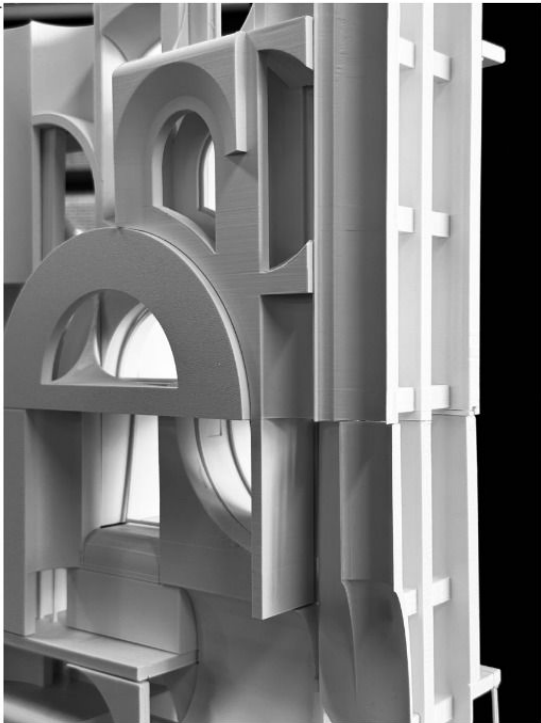

04 ADND SILO

PROFESSIONAL WORK

Programme : Office, Holiday Villa

Firm : Atelier Domain And Design

Work in-charge of: Design development, Post production, Documentation, Drafting existing conditions

The project focuses on the development of weekend villas and the renovation of office spaces, aiming to create functional and aesthetically pleasing environments for work and relaxation. My role involved contributing to the design and drafting of architectural plans, ensuring that the layouts were efficient and in line with the client's vision.

In addition to drafting, I was responsible for post-production work, enhancing presentation materials for client reviews. One of my key contributions was producing detailed digital renderings of the 3D views, allowing for better visualization of the project's spatial qualities and design intentions.

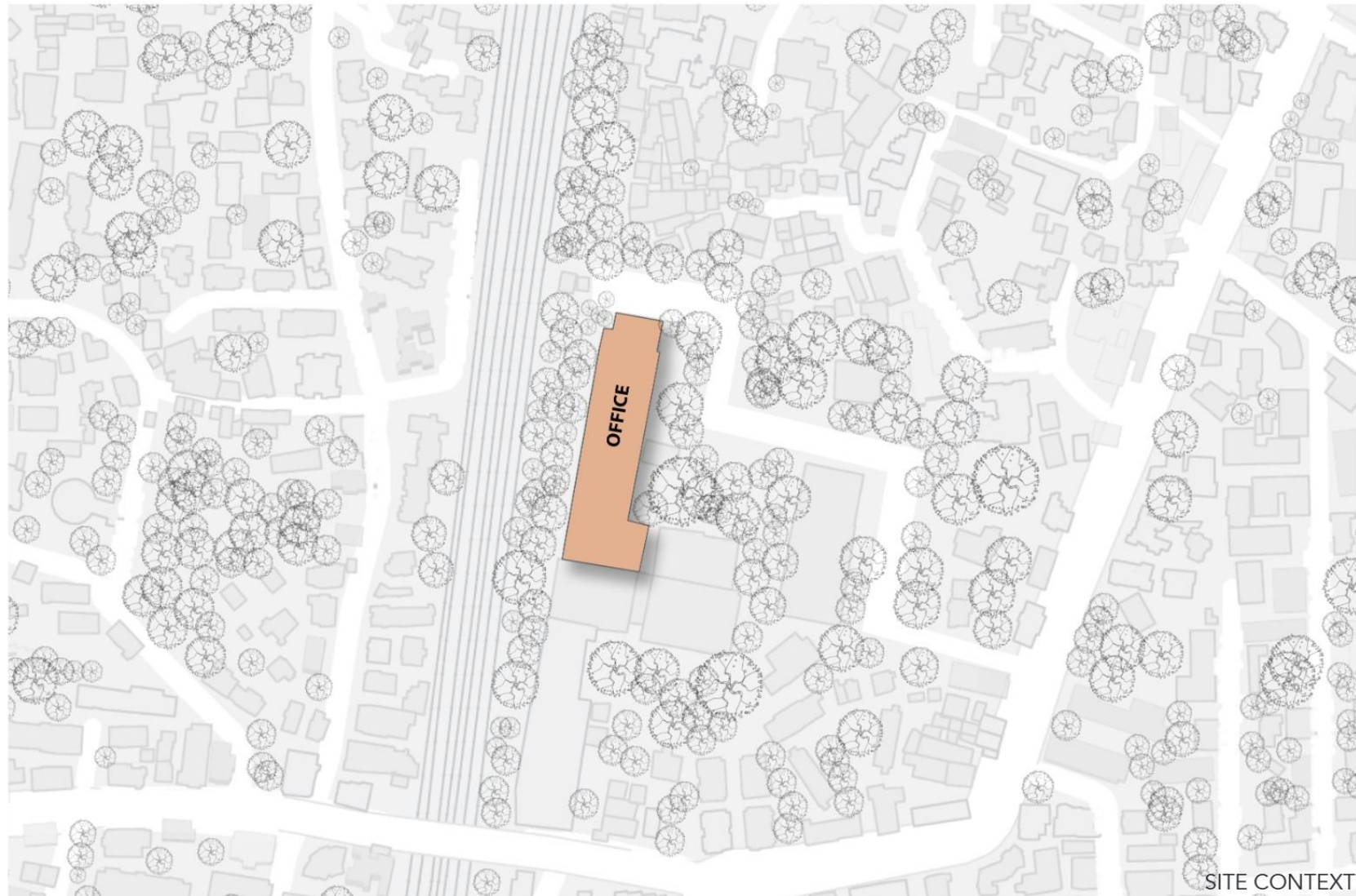

SITE CONTEXT

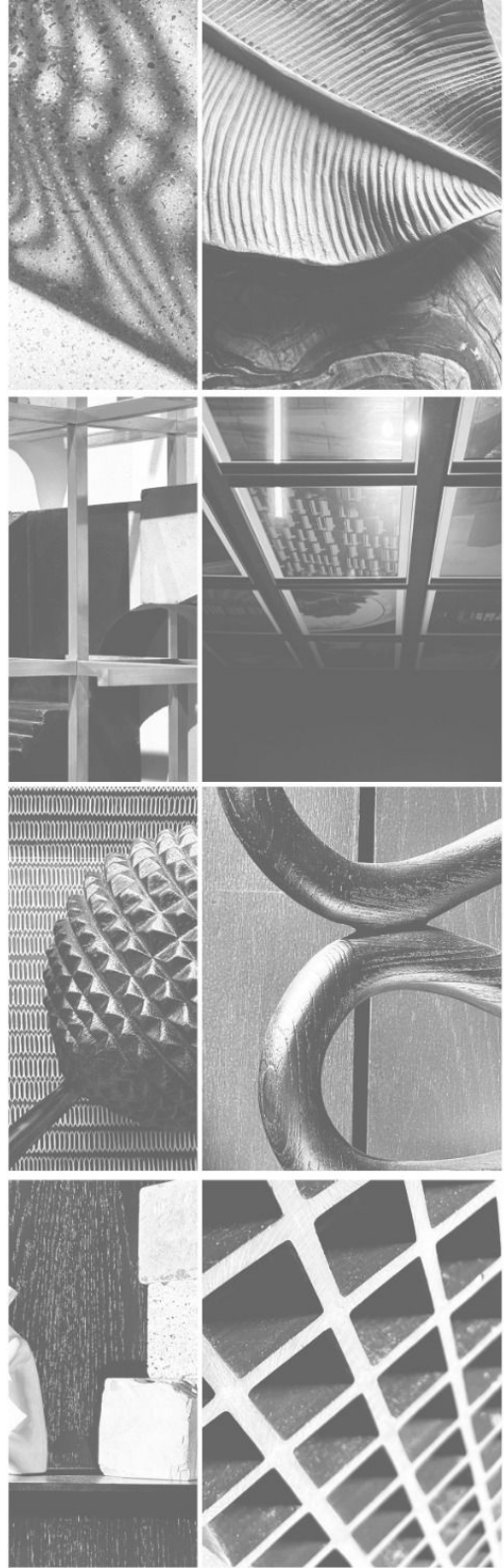

SECTIONS

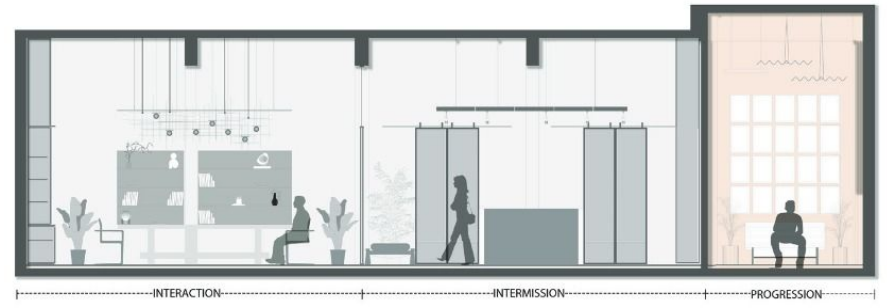
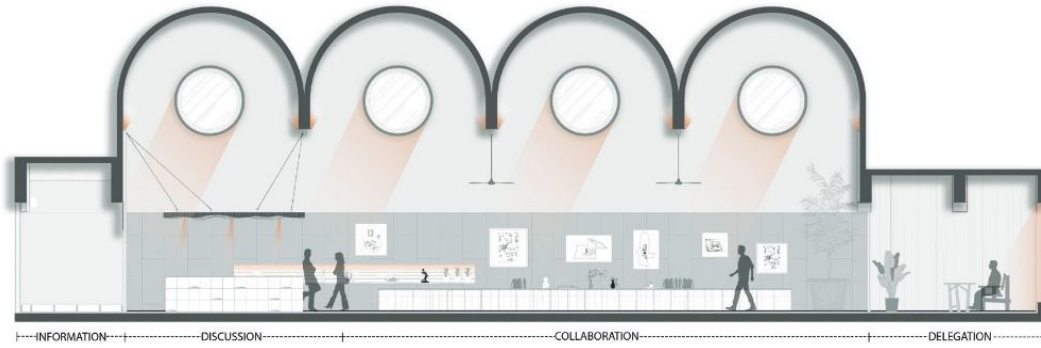

PLAN

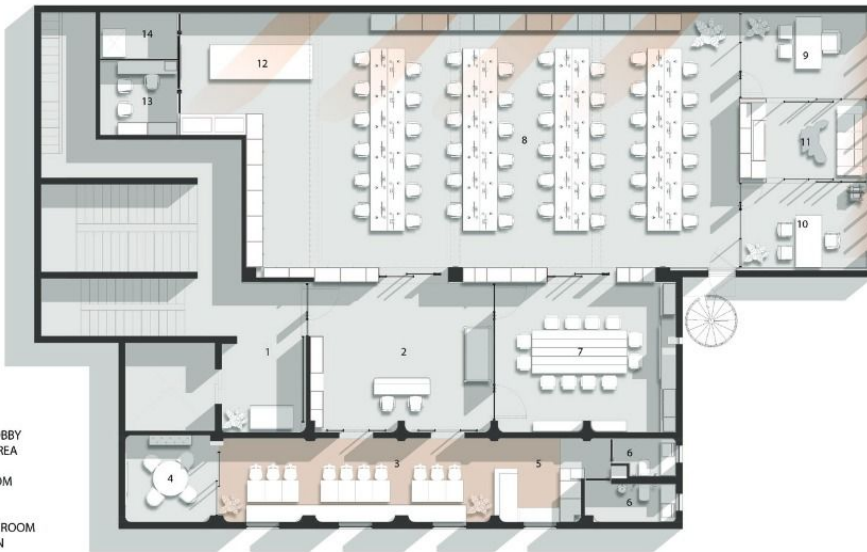

LEGEND

- 01. ENTRANCE LOBBY
- 02. RECEPTION AREA
- 03. CAFETERIA
- 04. MEETING ROOM
- 05. PANTRY
- 06. TOILET
- 07. CONFERENCE ROOM
- 08. WORKSTATION
- 09. CABIN 1
- 10. CABIN 2
- 11. LOUNGE
- 12. DISCUSSION SPACE
- 13. ACCOUNTS CABIN
- 14. SERVER ROOM

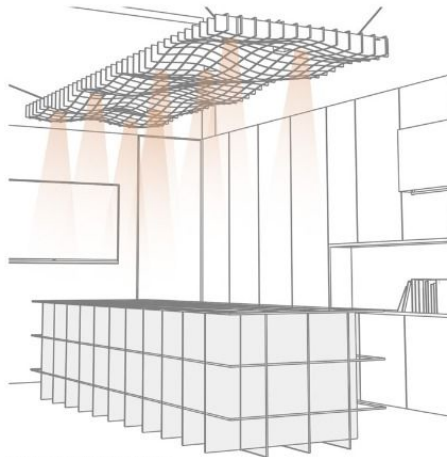
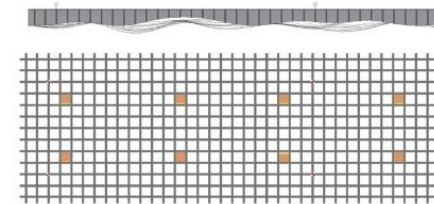

DISCUSSION TABLE AND LIGHT

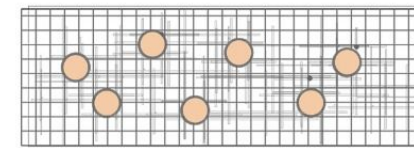
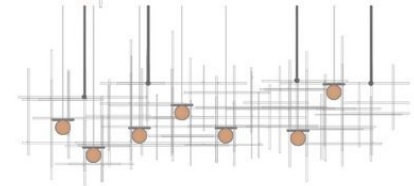
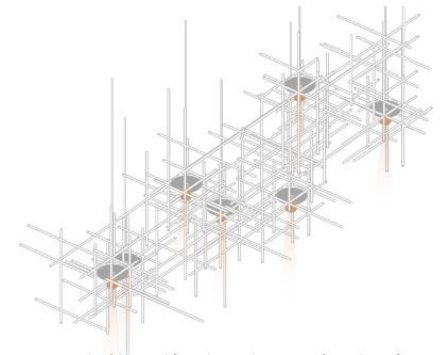

CONFERENCE ROOM LIGHT

OPEN ISOMETRIC OF OFFICE

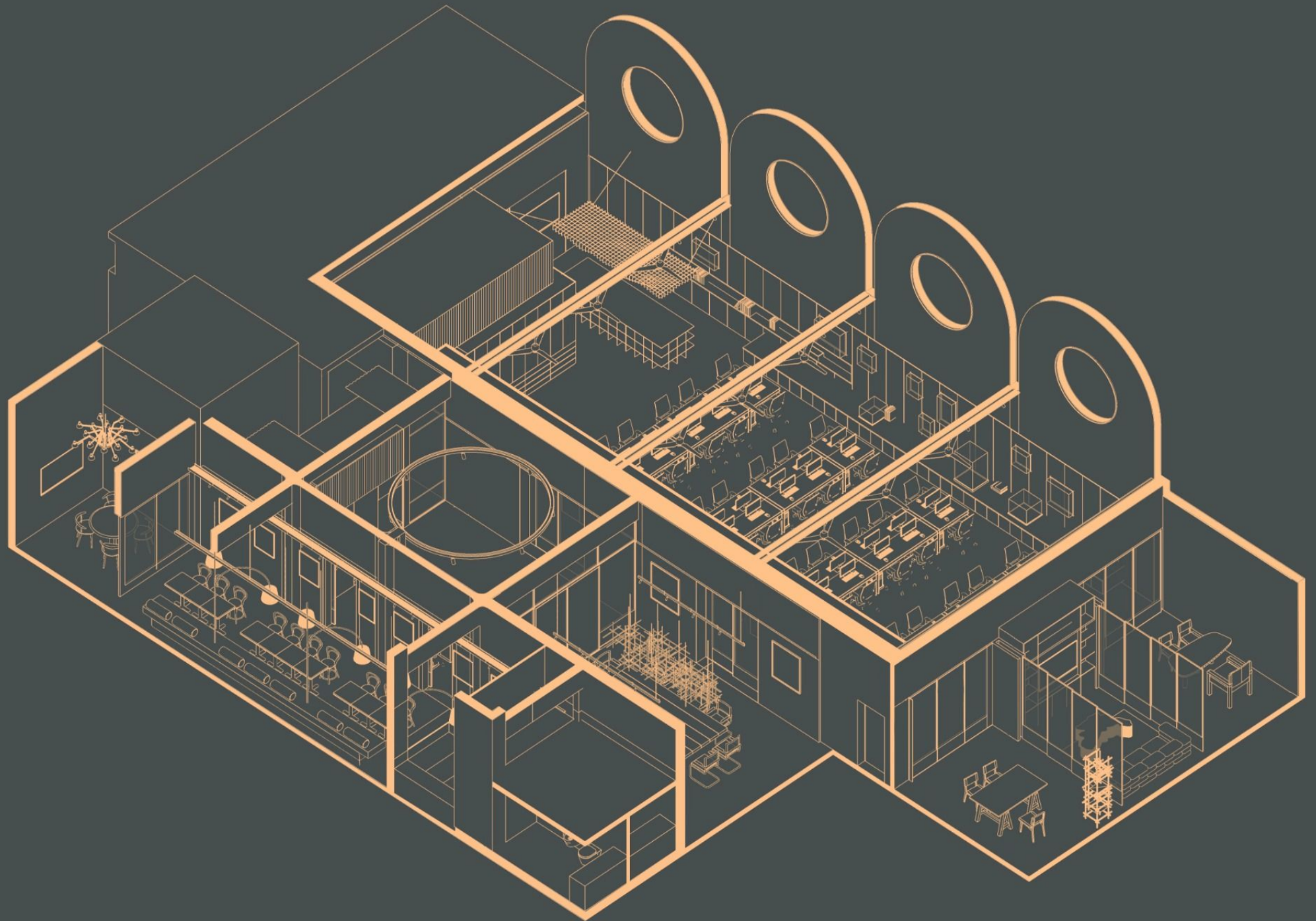

GAZEBO RENDERS



INTERIOR PROJECT FOR GOA VILLA



05 URBAN REGENERATION

DESIGN DISSERTATION - YEAR 5

Programme : Mixed-use market development

Mentor : Ar. Jagdish Jani

Site : Mangaldas Market, Kalbadevi

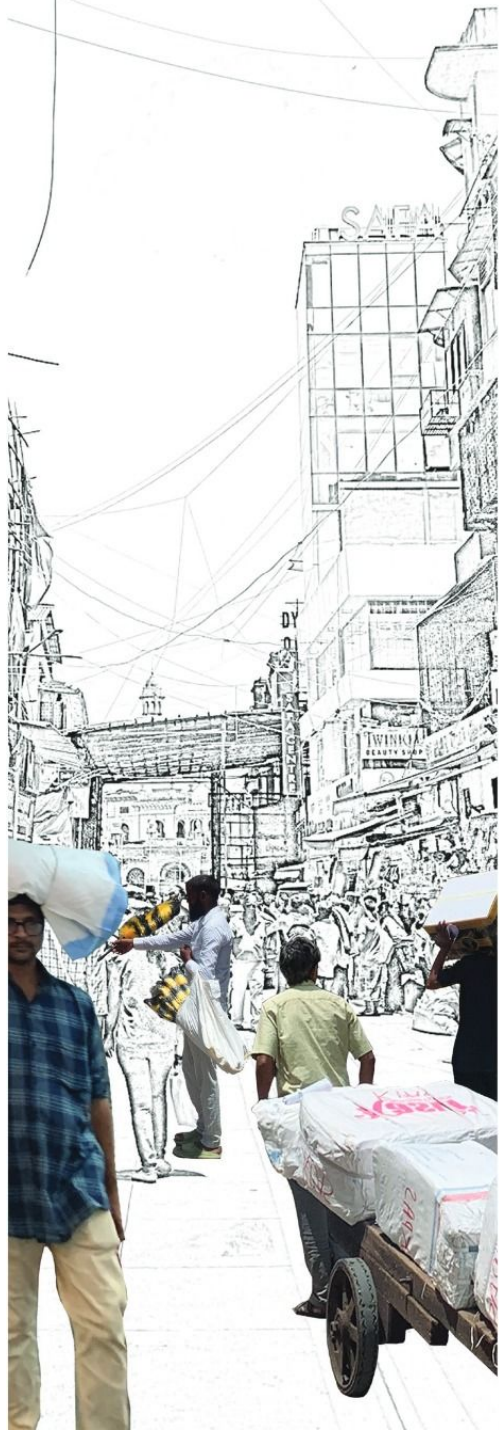

WHY IS REGENERATION REQUIRED?

SHIFT FROM WHOLESALE TO RETAIL

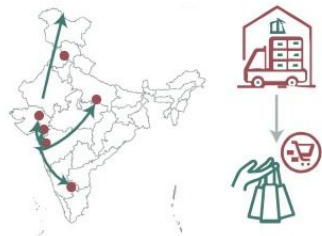

INCREASED DEVELOPMENT PRESSURE

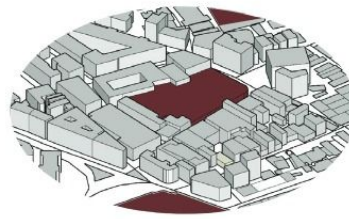

DEAD INTERIORS

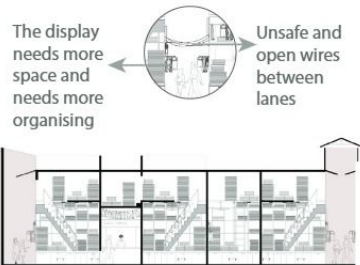

SHOPS NOT OPENING BECAUSE OF LESS SALE



RAPID GROWTH OF E-COMMERCE



NEED OF OPEN AND PUBLIC SPACES IN KALBADEVI

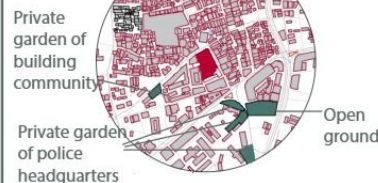

The aim of this dissertation is to set up or establish the importance of urban regeneration in architecture.

The thesis refers to the process of revitalizing neglected, deteriorated, or abandoned urban areas which have been created because of rapid population growth, economic changes, and social shifts, by using design and planning strategies to create new and dynamic spaces for a lasting urban development.

The aim is to address these issues by designing infrastructures and public spaces, revitalizing local economies, and enhancing social cohesion. It also examines case studies of successful and unsuccessful urban regeneration projects to draw lessons for future initiatives.

WHAT DOES IT ADD TO THE CITY, NEIGHBOURHOOD AND THE MARKET

CITY

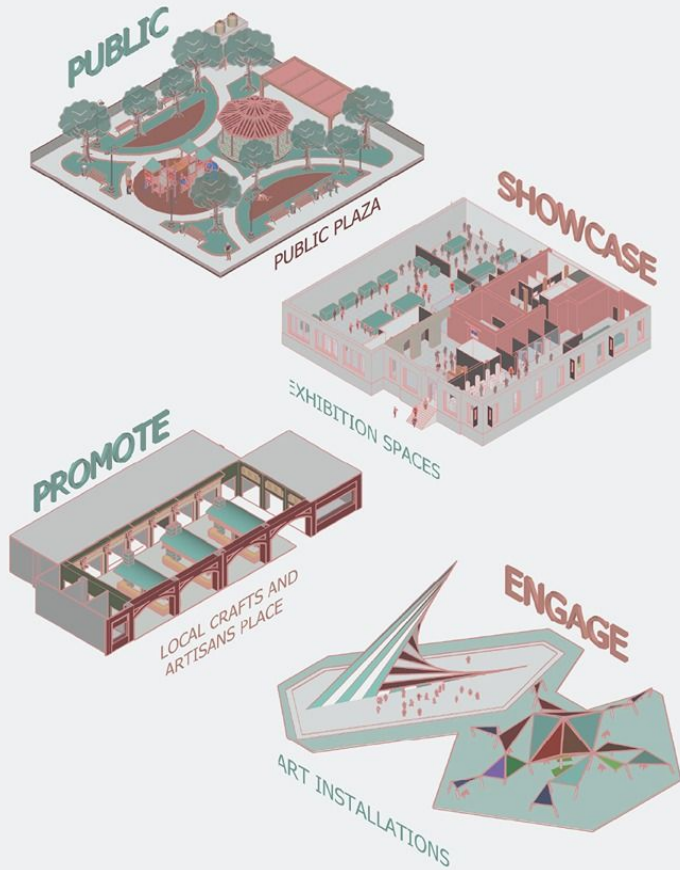

NEIGHBOURHOOD

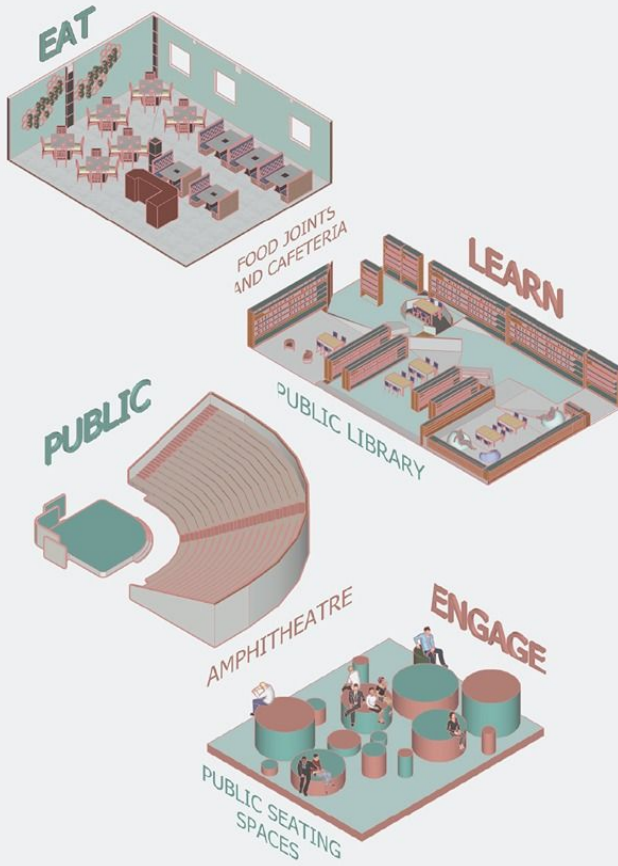

MARKET

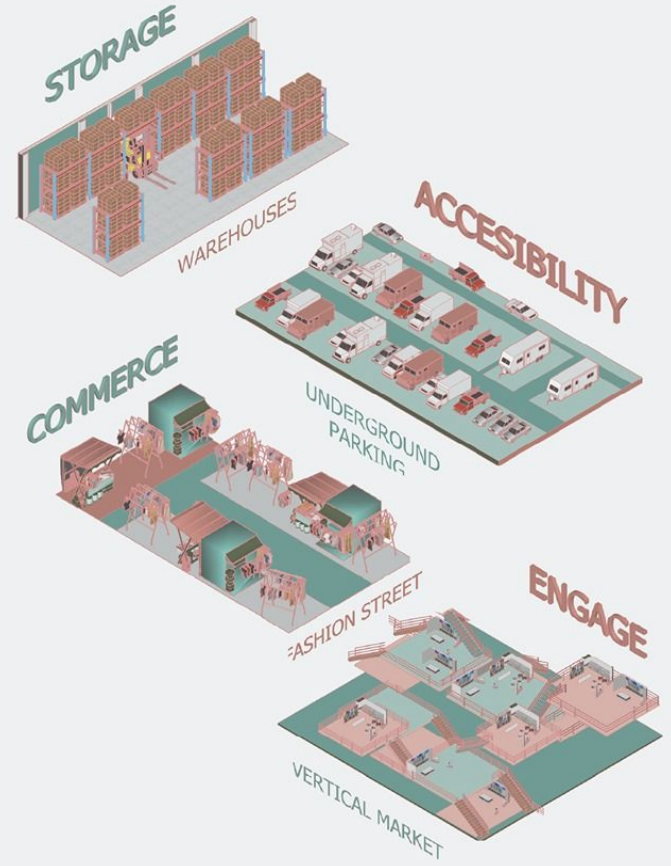

DESIGN STRATEGIES

CONNECTING THE MARKETS AS A SINGLE EXPERIENCE

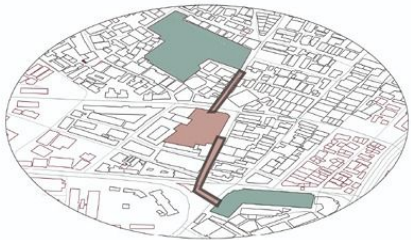

Enhances urban connectivity, fostering a cohesive social fabric.

OVERLOOKING GREEN COURTYARDS AND ATRIUMS

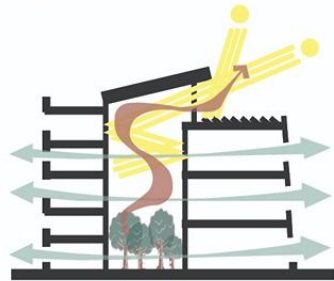

Integrate vertical openings and voids within the mass to enhance airflow and create visual interest.

UTILISING UNDERGROUND FOR PARKING AND STORAGE

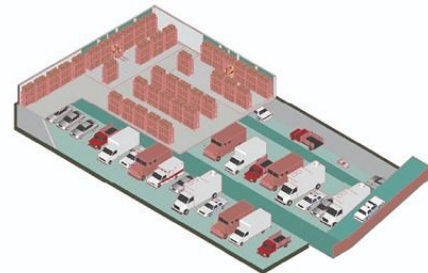

Preserving surface areas for community use.

INTERLOCKING VOLUMES AND SPACES

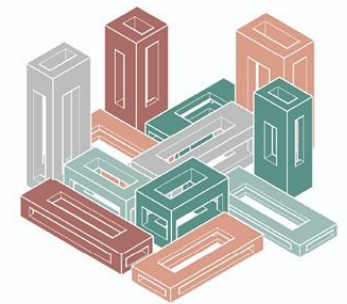

Height difference allows more visual connectivity, voids allow circulation.

AXONOMETRIC VIEW



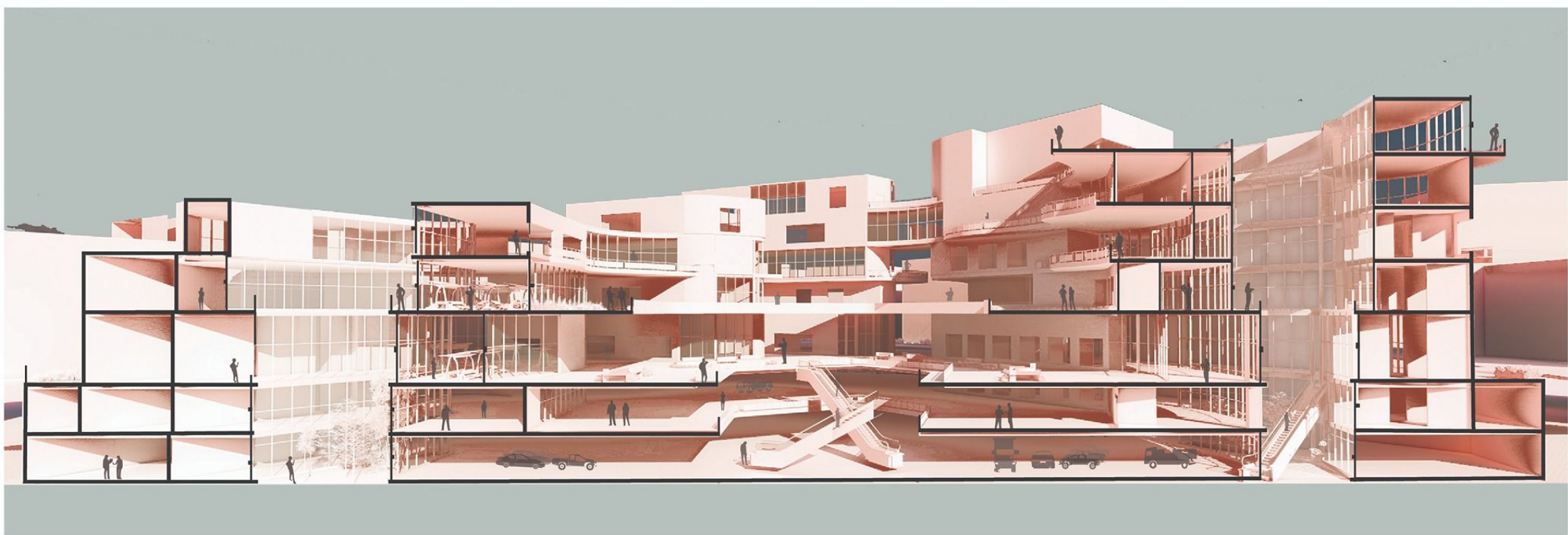

06 MULTI-MODAL TRANSIT HUB

DESIGN STUDIO - YEAR 4, SEMESTER 8

Programme : Transit Hub

Mentor : Ar. Ritu Mohanty

Site : Darukhana, Eastern Waterfront

The Mumbai Eastern Waterfront Plan sets out a framework for urban renewal and regeneration as the city looks towards resilient approaches for future growth and development.

The premise is a waterfront development site in Mumbai based on a planning approach envisioning expanded connectivity, more efficient transportation, great public buildings, valuable open space network within districts- each zoned for appropriate uses and densities.

Site selection was based on analysis of Mumbai Port Trust- MbPT's existing site opportunities & constraints, SWOT study based on current demand for space in Mumbai city and HCP's 500 Ha Mumbai Port Complex Master Plan.

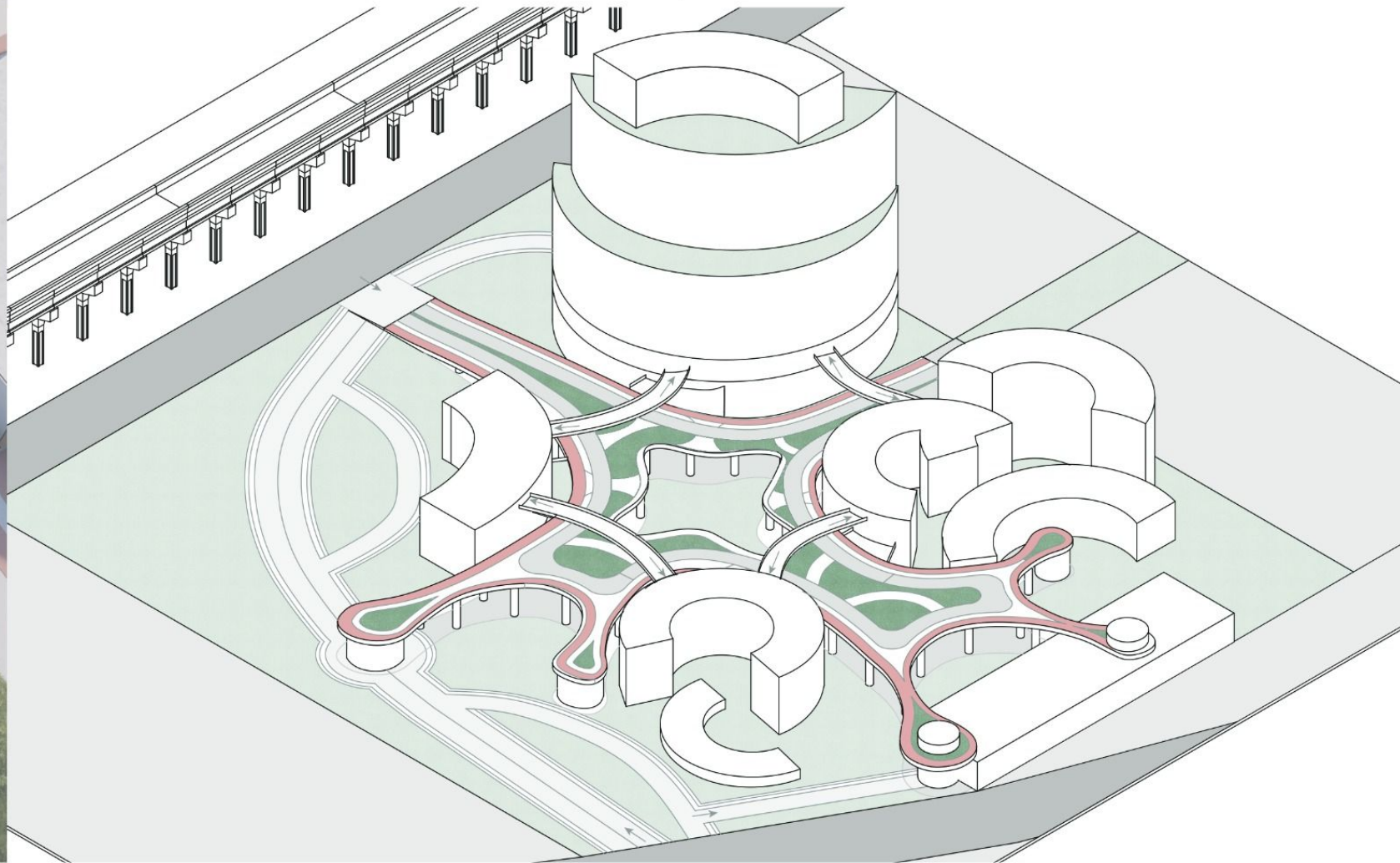
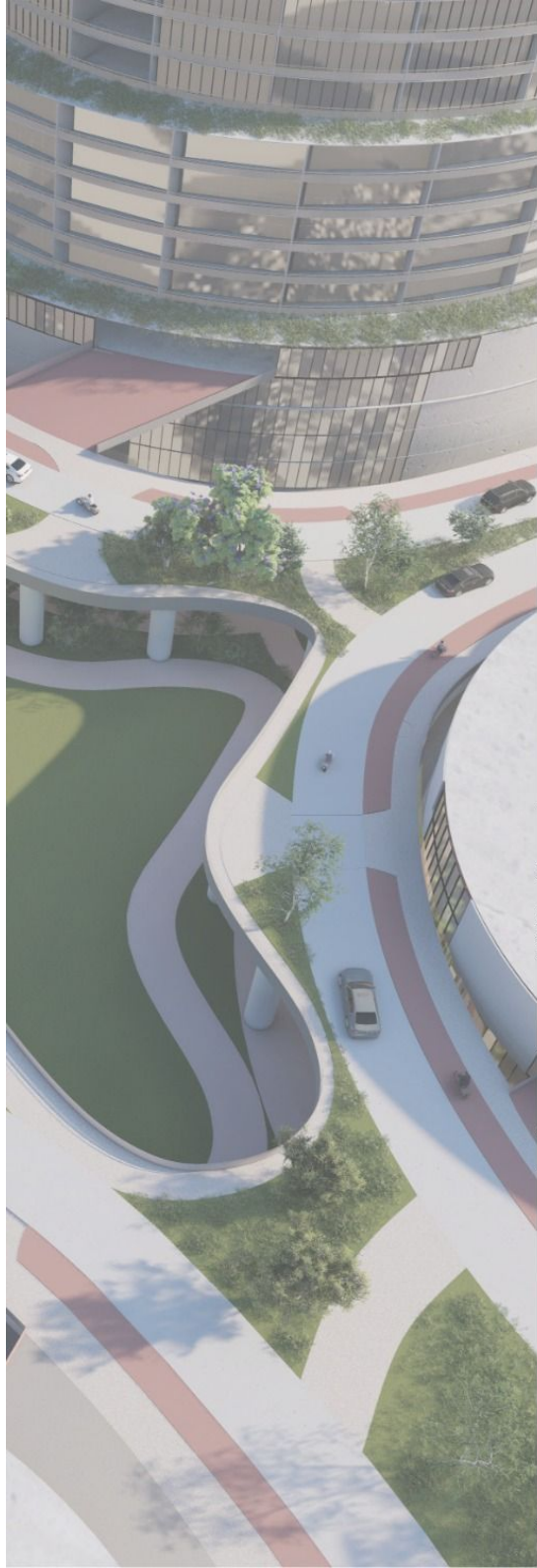

ROUTE MAPPING - DARUKHANA

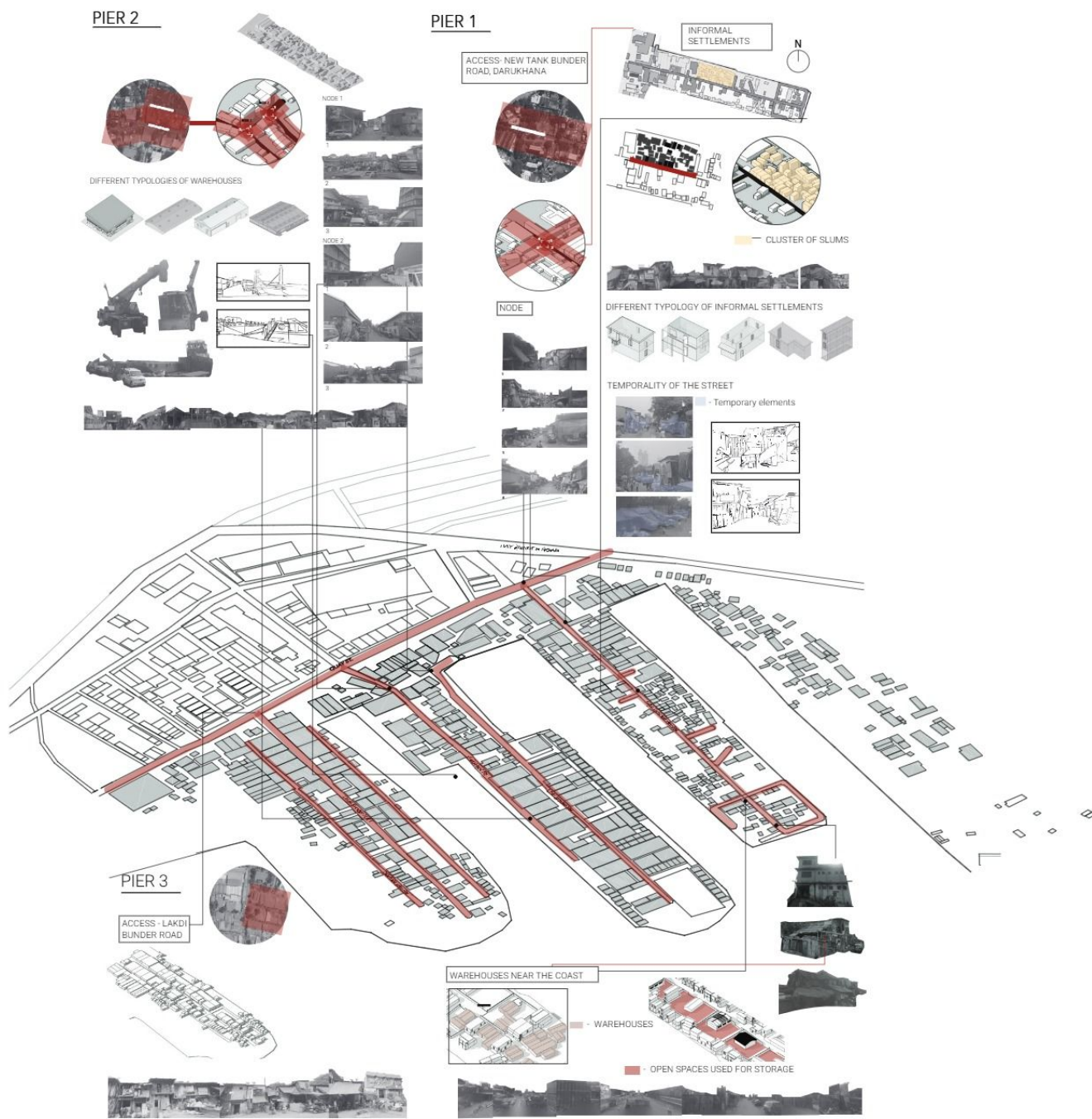

TRANSIT STRATEGIES

1. SHUTTLE SERVICE 
500 METER WALKABLE RADIUS

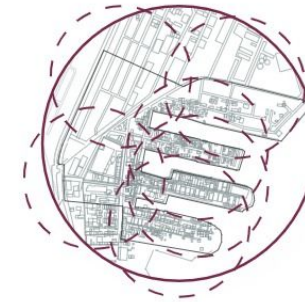

PROPOSED STOPS OF SHUTTLE



3. CYCLING TRACK 
EXISTING SECONDARY ROAD NETWORK



PROPOSED STREET SECTIONS

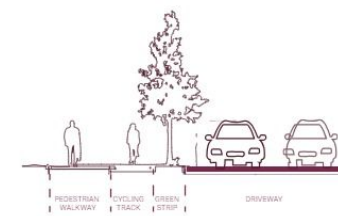

2. E-BIKE 
ONE CHARGING STATION FOR EACH SITE PARCEL



PROPOSED CHARGING STATION FOR E-BIKE



4. ELECTRIC RICKSHAW
PROPOSED CHARGING STATION FOR E-RICKSHAW



5. FERRY BOAT 
NUMBER OF DOCKS - 13

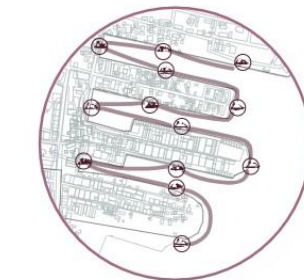

Darukhana, located in the Eastern Waterfront, has a long history of industrial activities. The area was traditionally home to shipyards and other heavy industries. It played a crucial role in Mumbai's maritime trade and shipbuilding activities. Over the years, the industrial landscape has changed significantly, with some older industries giving way to newer ones. As part of the Mumbai city's ambitious plans for transforming the Eastern Waterfront, several redevelopment projects were proposed to revitalize the area and unlock its potential for urban renewal, commercial growth, and public amenities.

GROUND FLOOR PLAN



FOURTH FLOOR PLAN



LEGEND

- | | | | | | |
|---------------------|----------------------|-------------------------|---------------------------|------------------|----------------------|
| 1. MAIN ENTRANCE | 8. CINEMA HALLS | 15. WAITING HALLS | 22. METRO STATION | 30. WAITING HALL | 38. RETREAT ENTRANCE |
| 2. INFORMATION DESK | 9. SERVICE ROOM | 16. HUB ENTRANCE | 23. EVENT COURTYARD SPACE | 31. CAFETERIA | 39. INFORMATION DESK |
| 3. WAITING HALL | 10. TICKET COUNTER | 17. RECEPTION | 24. MALL ENTRANCE | 32. CAR DROP-OFF | 40. SERVICE ROOM |
| 4. EVENT SPACE | 11. PARKING ENTRANCE | 18. BAGGAGE COUNTER | 25. RECEPTION | 33. RECEPTION | 41. WAITING ROOM |
| 5. INFORMATION DESK | 12. PARKING | 19. LOCKER ROOM | 26. SHOPS | 34. WAITING HALL | 42. RECEPTION |
| 6. SHOPS | 13. RETREAT ENTRANCE | 20. COMMERCIAL BUILDING | 27. SERVICE FLOOR | 35. KITCHEN | 43. BAGGAGE COUNTER |
| 7. CAR DROP-OFF | 14. INFORMATION DESK | 21. SURFACE PARKING | 28. THEATRE ENTRY | 36. RESTAURANT | |
| | | | 29. RECEPTION | 37. TERRACE | |

The idea was to have an elevated park which incorporates a cycling track and a walking track and has access to every single building designed on the site. The courtyards in between the masses add up to the visual connectivity. The curvy form increases visibility - no edges, no hidden corners or dead ends and creates a sense of fluidity and movement. The form reduces congestion by creating more natural pathways for people to follow since there will be a lot of foot traffic.





PAWNA PROJECT

PROFESSIONAL WORK

Programme : Holiday Villas

Firm: RH(A+D) Architects

Site: Pawna, Maharashtra

Work in-charge of: Drafting plans, Digital model, Plan Renderings

Manifestation of our collective spiritual sensibilities.

The homes are designed to capture the zest of life and the raw beauty of nature. Each home rise from the Earth, like an uncut diamond in the rough, using natural surroundings and geological elements to create a luxurious habitat with modern amenities.



Proposed Master Plan

- Plot 1 : 4000 sqm
- Plot 2 : 3000 sqm
- Plot 3 : 3013 sqm
- Plot 4 : 3000 sqm
- Plot 5 : 4000 sqm
- Plot 6 : 4065 sqm



LEGEND

- | | |
|----------------------------|-----------------------|
| 1. PLOT ENTRY | 12. WATERWALL |
| 2. TENNIS COURT | 13. CASCADE |
| 3. DRIVEWAY | 14. GROTTA |
| 4. PARKING | 15. MOAT |
| 5. GRAVEL COURT | 16. STREAM |
| 6. LAWN | 17. VALLEY OF FLOWERS |
| 7. DECK | 18. TIERED GARDEN |
| 8. SHRUBBED | 19. PERGOLA |
| 9. CLIFF | 20. BRIDGE |
| 10. ROCK OUTCROP | 21. SECURITY CABIN |
| 11. INFINITY SWIMMING POOL | |

*Proposed Site layout. Final layout may differ.

Proposed Floor Plans

Entry Level Plan

- | | |
|--|-------------------------------------|
| 1. Entry Gate | 14. Utility |
| 2. Security Cabin | 15. Bedroom 2 (18' x 20'-6") |
| 3. Servant Room | 16. Bedroom 3 (15'-6" x 27') |
| 4. Parking | 17. Outdoor Ribbon-Deck |
| 5. Main Entrance | 18. Boulder Walls w Planters |
| 6. Entry Foyer (6' x 11'- 6") | 19. Infinity Pool |
| 7. Lounge / Multi-utility Room (16'-6" x 24'-6") | 20. Steam / Sauna Room (8'-6" x 9') |
| 8. Formal Seating w Fire Place (36' x 24') | 21. Waterfall |
| 9. Dining | 22. Lawn 1 |
| 10. Open Kitchen (19' x 11'-6") | 23. Lawn 2 |
| 11. Powder Toilet | 24. Lawn 3 (at upper level) |
| 12. Outdoor Shower | 25. Walking Track |
| 13. Elevator | 26. Sunset Deck |



Proposed Floor Plans

Lower Level Plan

- 27. Master Suite (18' x 25')
- 28. Deck
- 29. Zen Garden

*Proposed Floor Plans of a home in Zazen. Final layout may differ.



The residences are crafted with a focus on mitigating thermal bridging, incorporating architectural elements to minimize heat transfer between interior and exterior spaces.

A well-structured waterproofing and drainage system is integrated to effectively manage stormwater on the premises, ensuring efficiency and resilience against heavy rainfall.

Pitched roofs and expansive canopies are strategically implemented to offer shelter from monsoon conditions, while skylights are strategically placed to optimize natural daylight within the interiors, fostering a well-lit environment.

09 ARCHITECTS ARENA

COMPETITION

Programme : Office space
 Organiser : Archmello
 Prize : Honourable mention

"Office /Workshop / Studio holds a significant place in every designer's life because from this very workplace your concepts turn into reality. Our profession involves a ton of creative thinking, brainstorming discussions, critical decision making & infinite selections and it is important that our workspace should be inspiring & motivating for you and your team. Your studio should be like a mirror, it should reflect what you do, how you do & what you are capable of doing.

The challenge is to design an architecture/interior design studio with workspace for 20-40 people. The aim of the competition is to design a studio which is open for design dialogues a studio that is innovative in terms of its architecture & interiors and a studio that is beyond glass cubicles & breaks the monotony of a conventional office." - Brief by Archmello



BIOPHILIA

The COVID-19 pandemic has increased people's awareness of one's rejuvenation and healing needs. The post-pandemic world necessitates us balance the needs of communities while allowing nature to thrive. We believe that the amalgamation of biophilic elements into a workspace has the capacity to bring a vital shift. Close proximity to nature has proven to promote productivity and overall well-being in a working environment. Our project aims to take inspiration from natural elements and give the designers a feel of working in nature.

FORM DEVELOPMENT

GENERATING TERRAIN

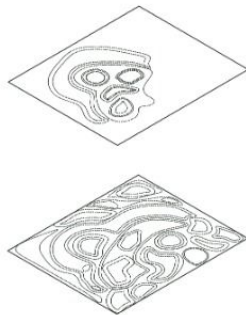

DEFINING ZONES

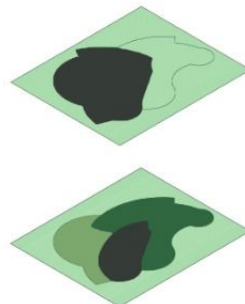

OVERLAYING CONTOUR LINES

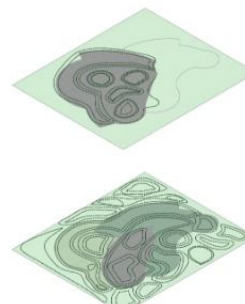

PROGRAMMES

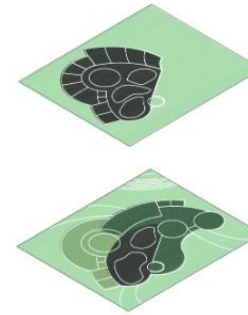

GENERATION OF LEVELS

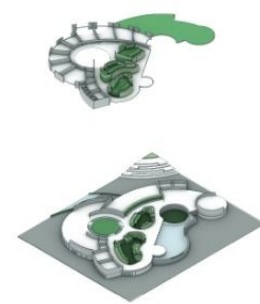

FIRST FLOOR TERRAIN

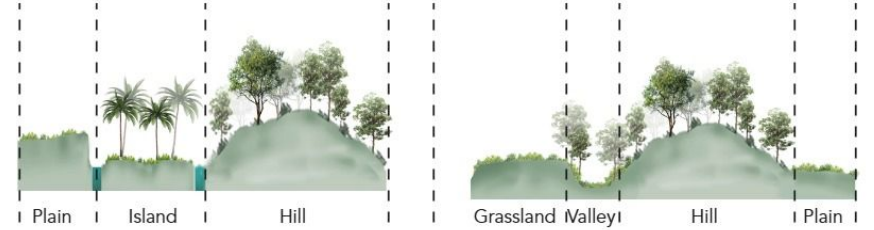

GROUND FLOOR TERRAIN

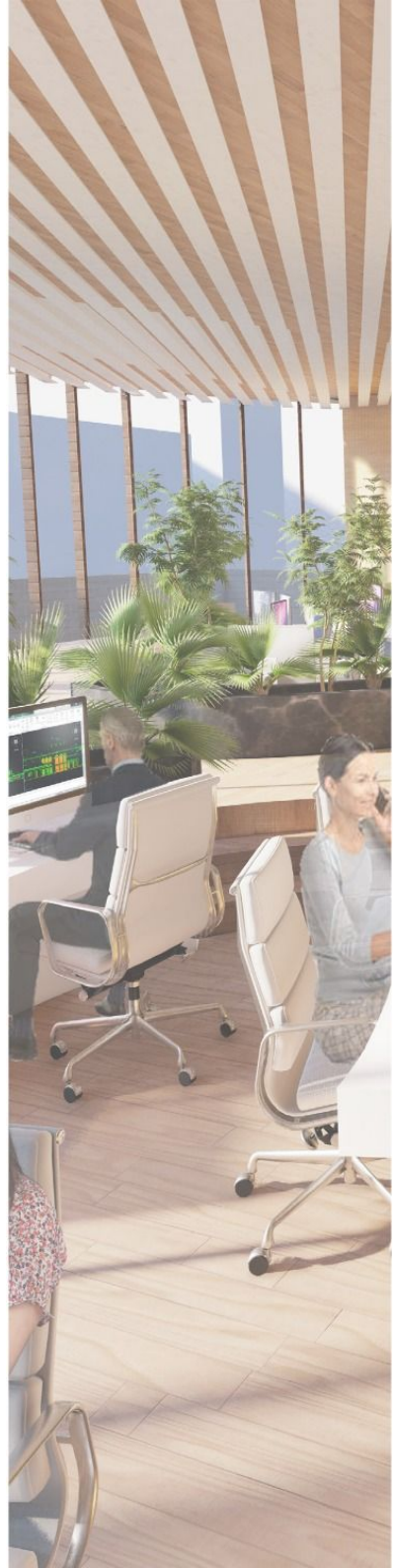
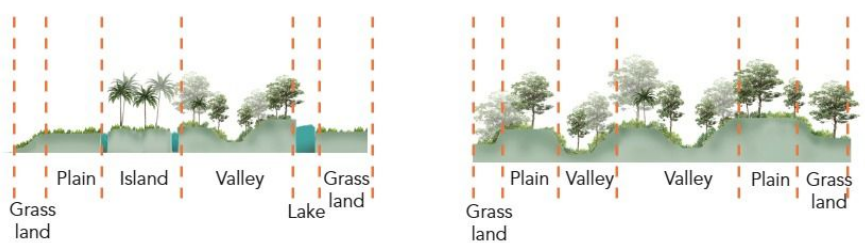

GROUND FLOOR PLAN



FIRST FLOOR PLAN

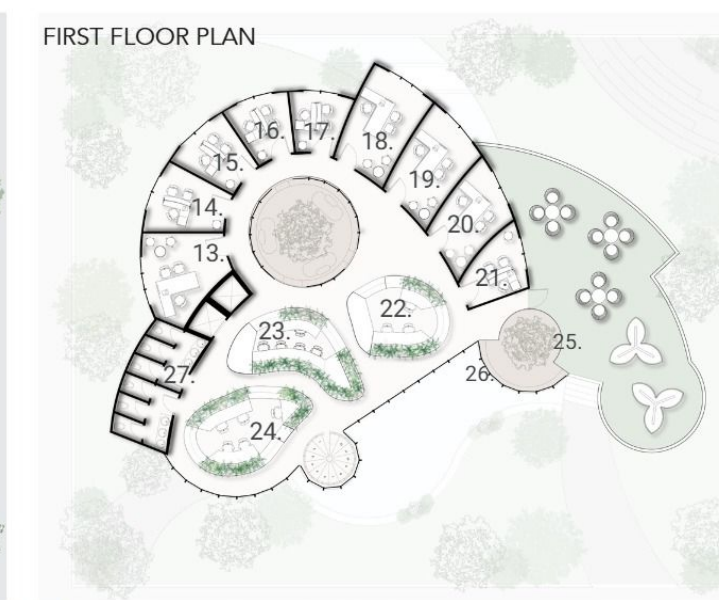

EXPLODED AXONOMETRIC

GROUND FLOOR

1. Lobby
2. Staircase
3. Breakout Space/
Exhibition Area
4. Brainstorming
room/ Exhibition Area
5. Working area (
Interior designers)
6. Working Area (Site
coordinators and HR)
7. Conference Room
8. Washroom
9. Lift
10. Reading and
Material library
11. Breakout Space
12. Washroom



FIRST FLOOR

- 13.- 21. Cains for architects
22. Working area (Junior
Architects)
23. Working area (3D
Modelling artists)
24. Working area (Structural
engineers and draftsmen)
25. Terrace
26. Courtyard
27. Washroom



get in touch!

kavya saxena

+1 (267) 3619872

kavyasaxena60@gmail.com